

MaisonTraction

PLANNING DATA

1. General description

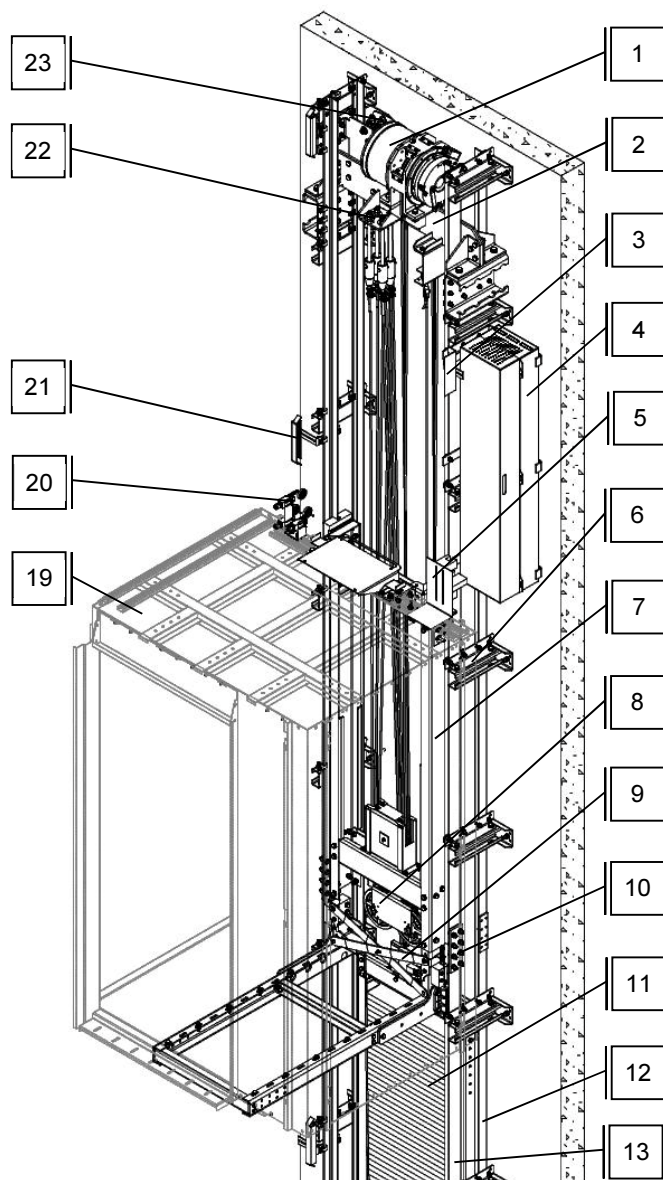

1. Traction machine
2. Traction machine base
3. Landing indicator bracket
4. Controller cabinet
5. Landing indicator
6. Guide rail brackets,
for car and counterweight frames
7. Car frame
8. Overspeed Governor
9. Safety gear system
10. Guide rail fishplate
11. Counterweight frame
12. Counterweight guide rails
13. Car guide rails
14. Counterweight buffer
15. Maintenance security system
16. Counterweight screen
17. Car buffer
18. Plate for car & counterweight guide rails support
19. Car
20. Limit switches
21. Cam
22. Car rope wedge socket
23. Counterweight rope wedge socket

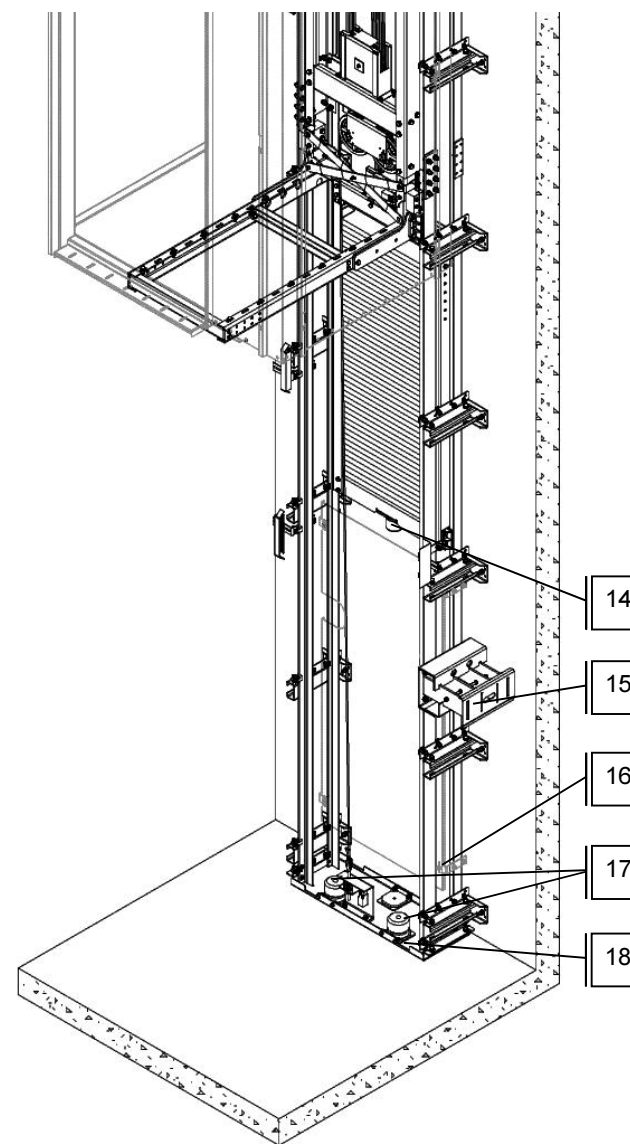

2. Technical specifications		
Rated Load (Kg)	320	400
max Travel (m) / Number of stops	12 / 6	
Car speed (m/sec)	0.15 - 0,40	
min Pit Height (mm)	200	
min Headroom Height (mm)	2600	
Car Sling Weight (Kg)	150	
Max Empty Car Weight (With Doors) *	810	680
Max Car Dimensions	1000 x 1250	1100 x 1400
Car/Cwt guide rails	T75x62x10 / T50x50x5	
max Vertical Distance between brackets (mm)	1250	
Type of Wire ropes	Ø8 DRAKO 25OT (min Breaking Load=43300 Nt)	
Numbers of Wire ropes	3 x Ø8	4 x Ø8
Machine Type	TORIN VM-450	
Rated output power (Kw)/Rated current (A)	1.1Kw / 5,6A	
Torque on axle (Nm)	100	138

* The max empty car weight it's for traction sheave with groove angle 80°
 Lifting platform compiles to 95/16/EC

3. FORCES ON THE SHAFT

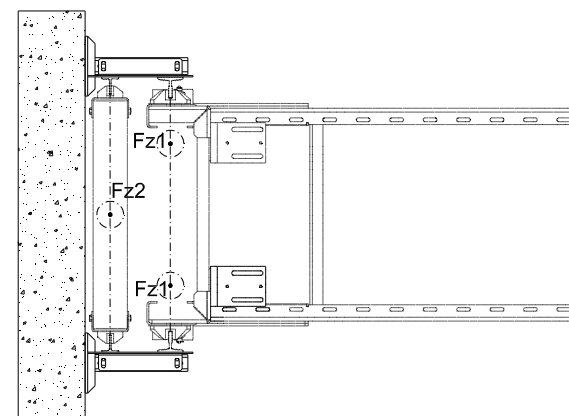
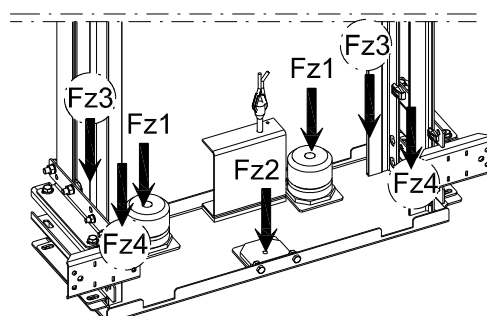
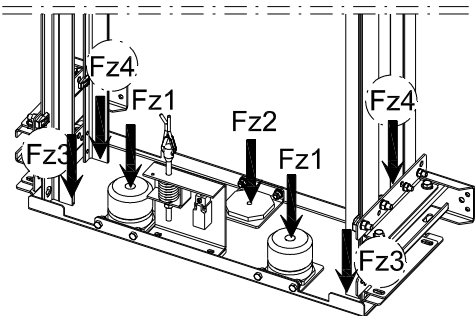
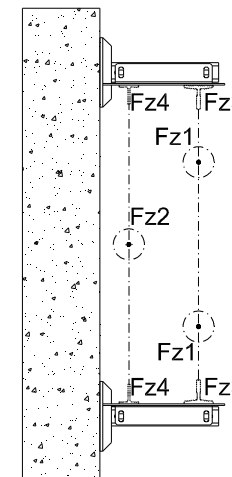
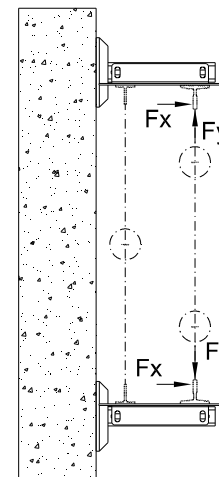
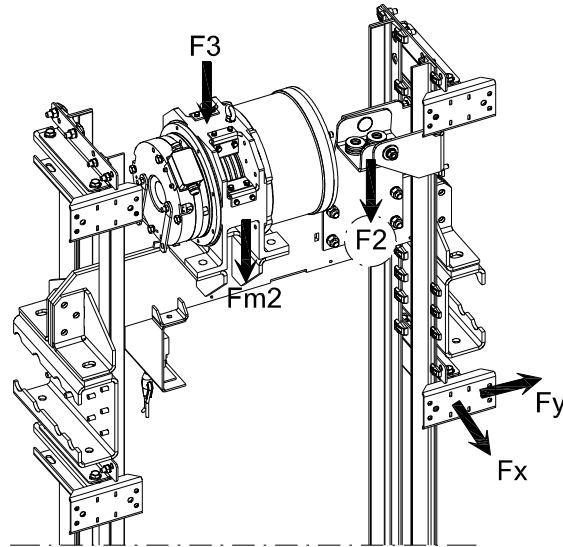
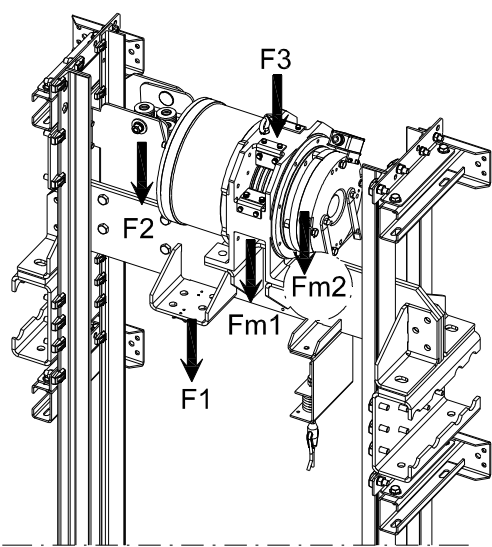

FORCE (Nt) RATED LOAD	F_1^*	F_2^*	F_3	F_{m1}	F_{m2}	F_x	F_y	F_{z1}	F_{z2}	F_{z3}	F_{z4}
320 Kg	6510	2510	9020	6510	2510	4690	740	19030	31780	14530	2510
450 Kg	7010	3010	10020	7010	3010	5370	1050	21580	34340	16450	2760

*Forces calculation during motor braking

320Kg - 1000x1250mm - 2 panel side opening

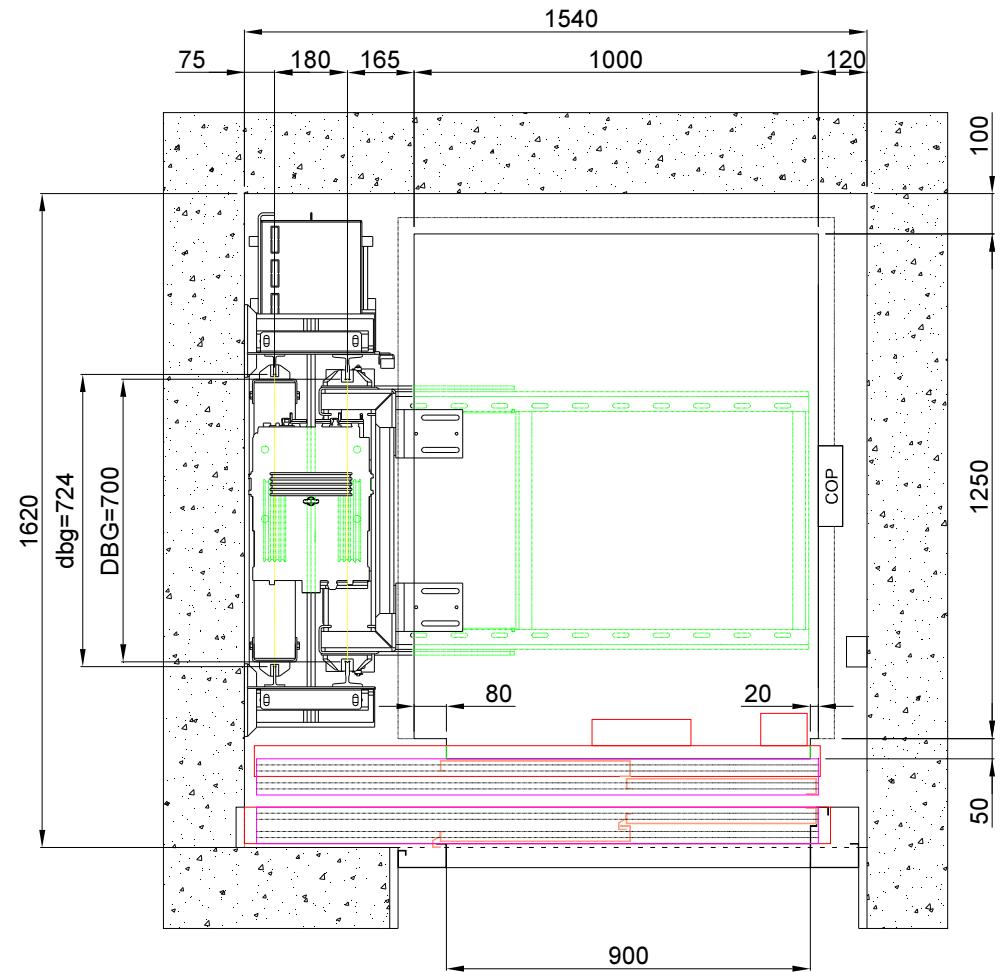
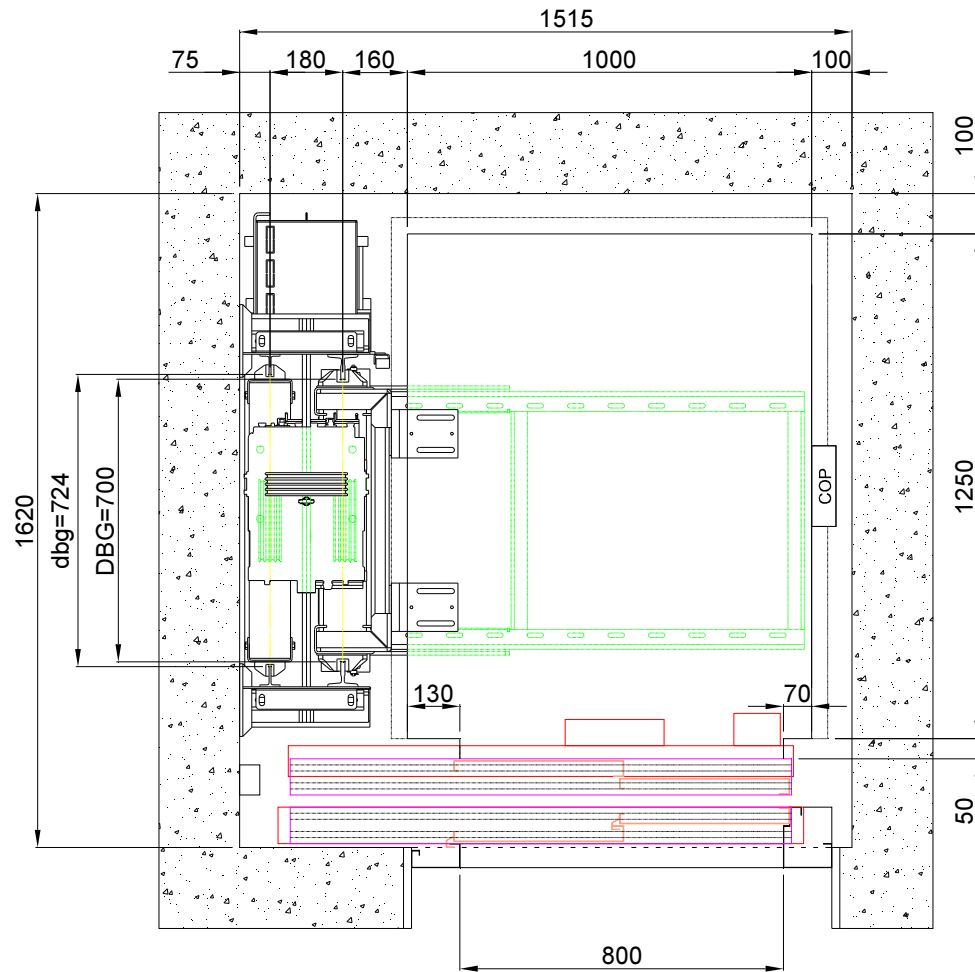

320Kg - 1000x1250mm - 2 panel side opening

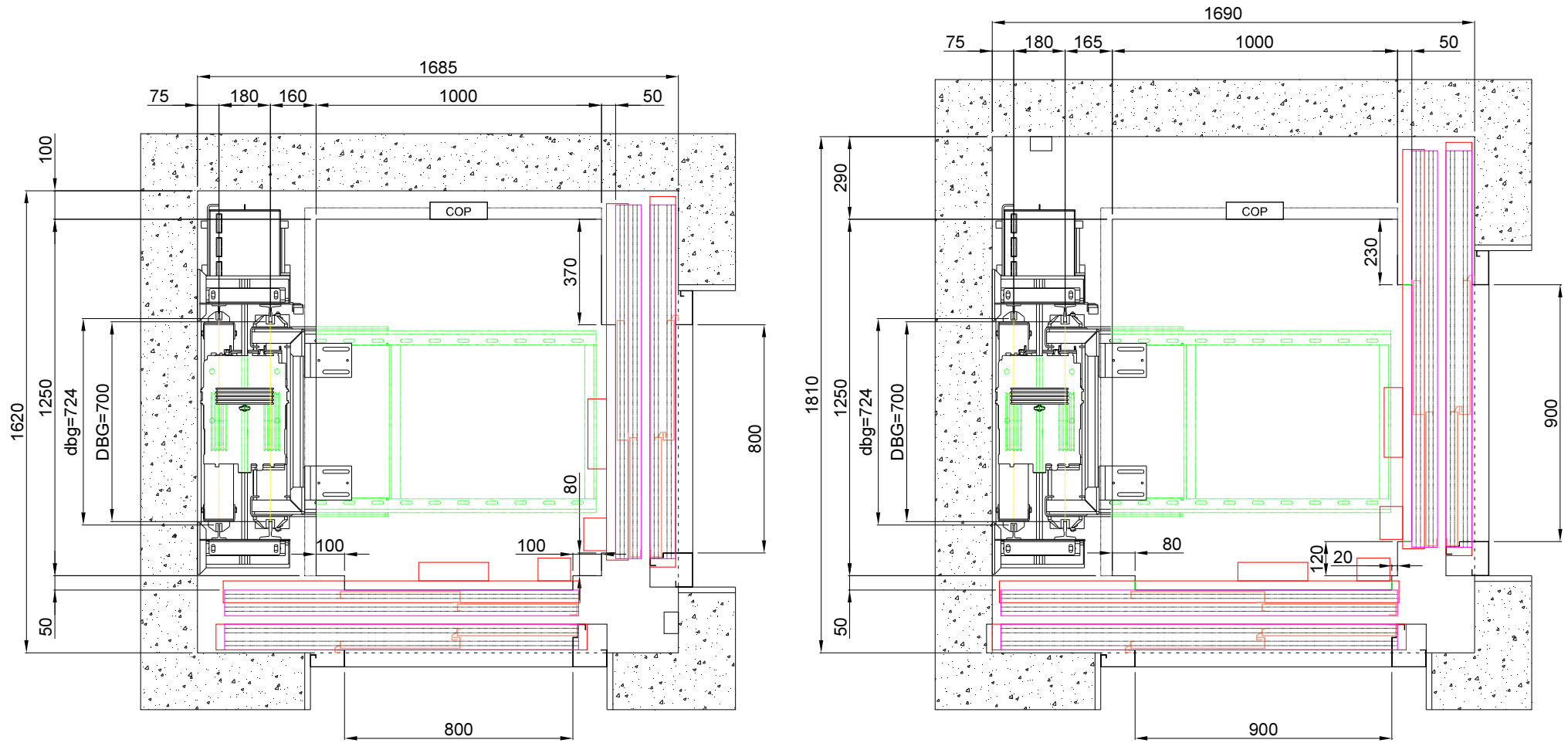

320Kg - 1250x1000mm - 2 panel side opening

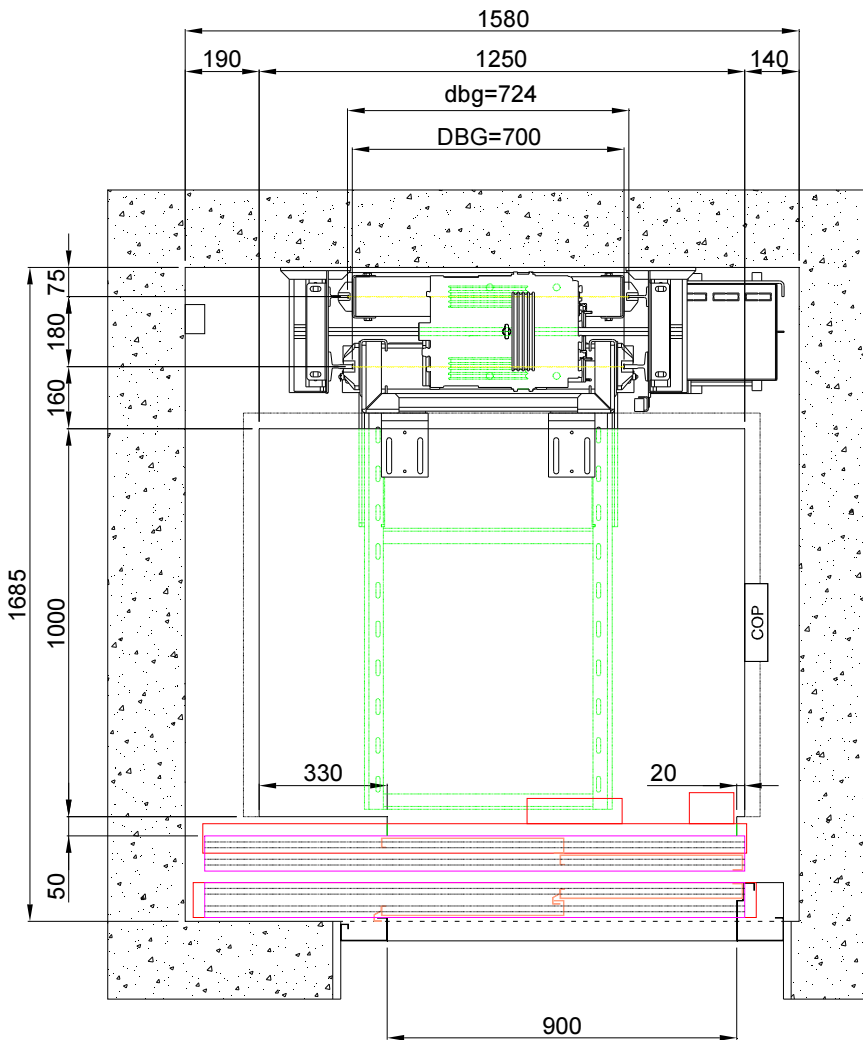
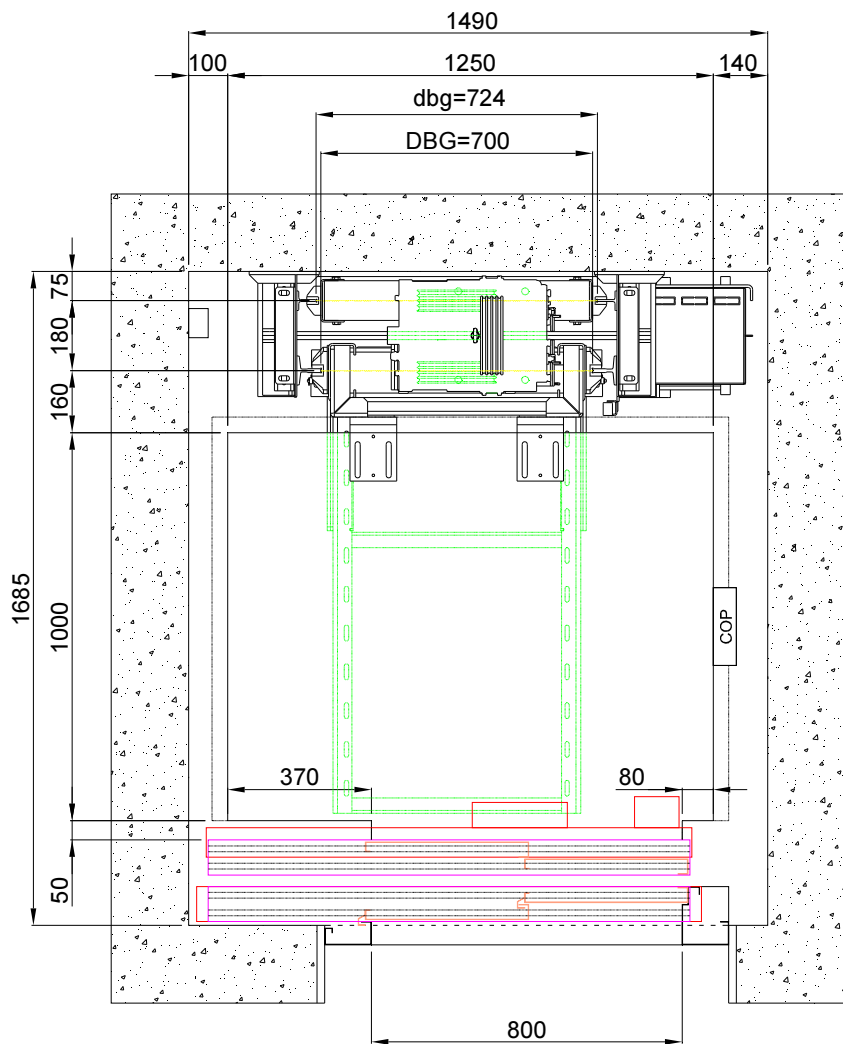

320Kg - 1000x1250mm - 2 panel center opening

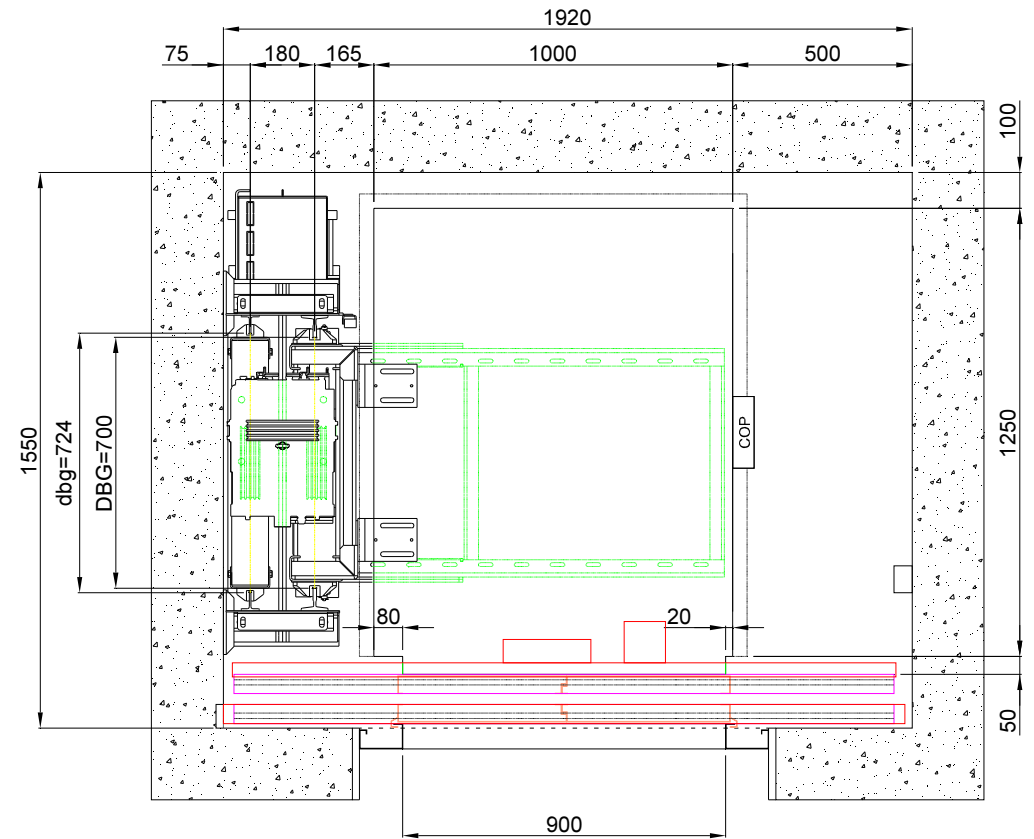
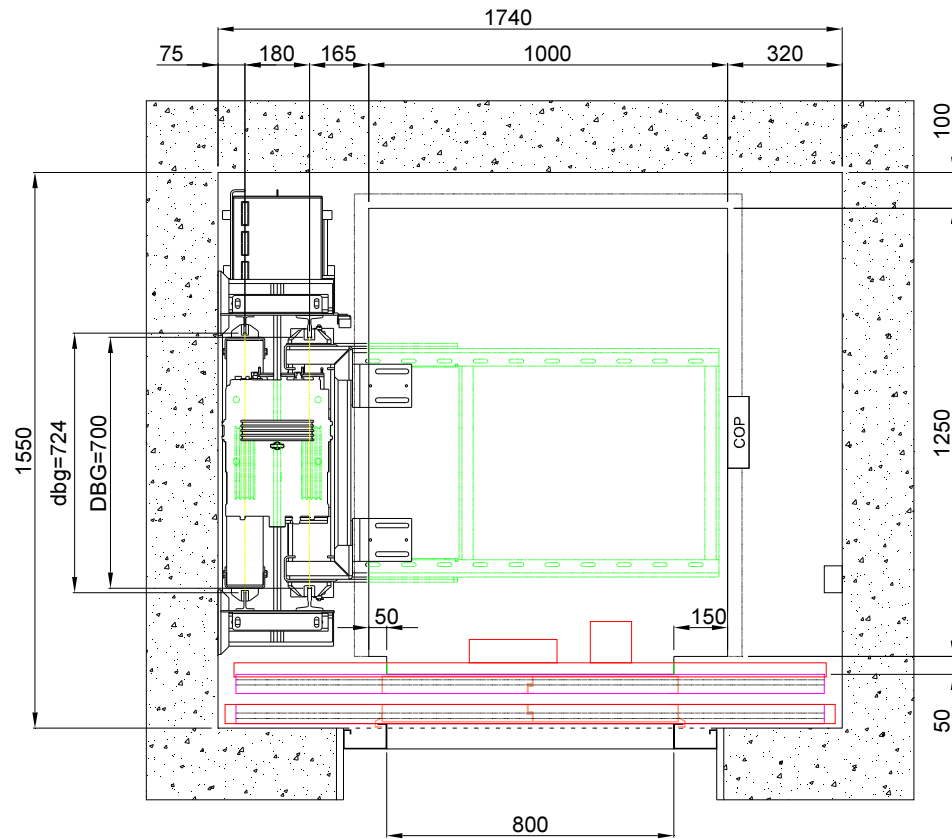

320Kg - 1250x1000mm - 2 panel center opening

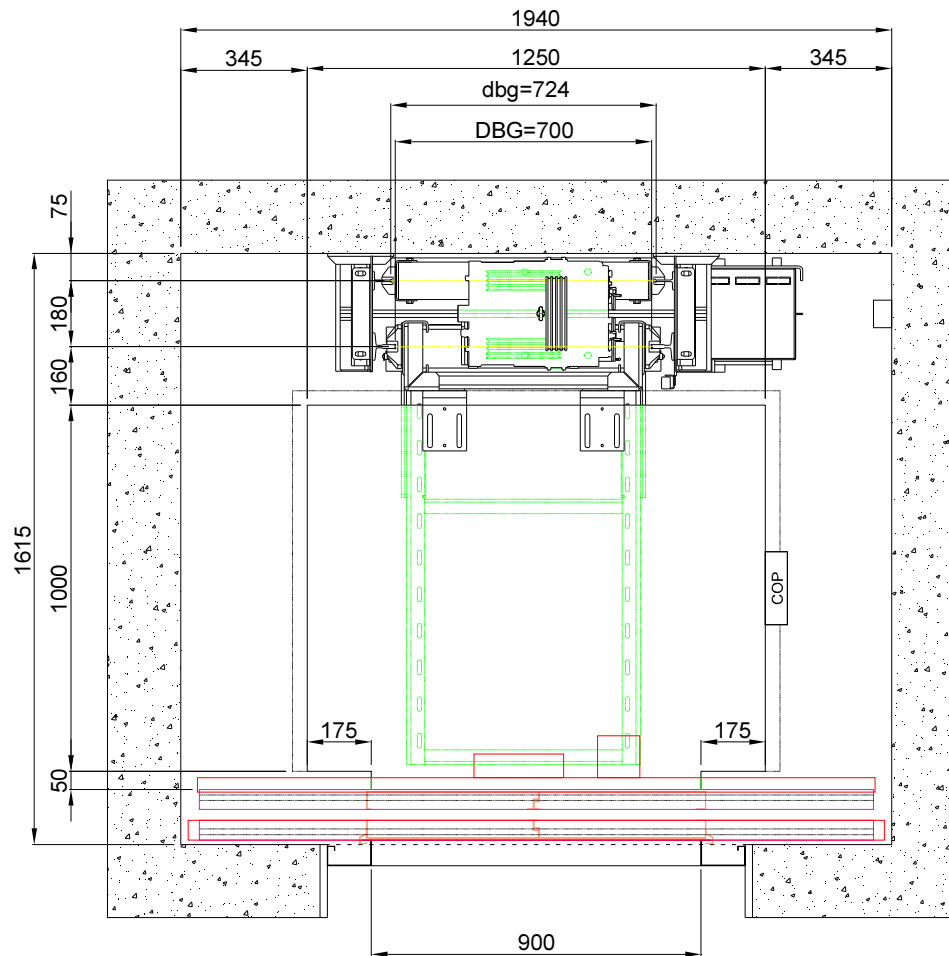
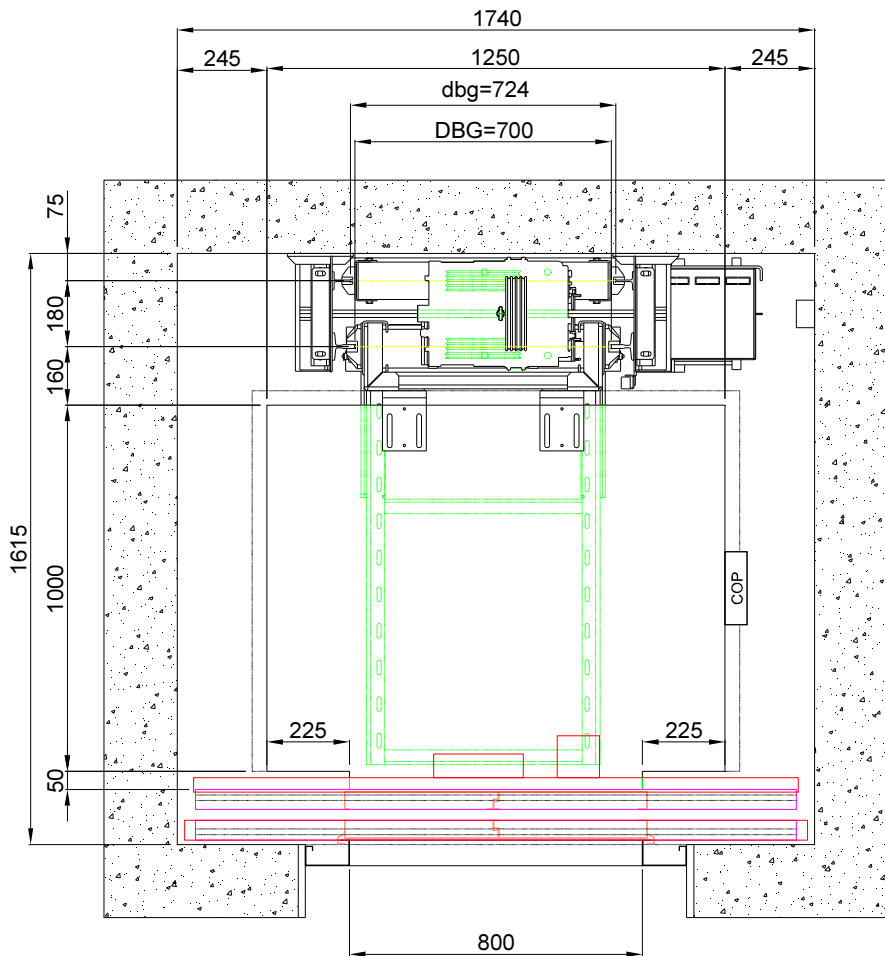

320Kg - 1000x1250mm - 4 panel center opening

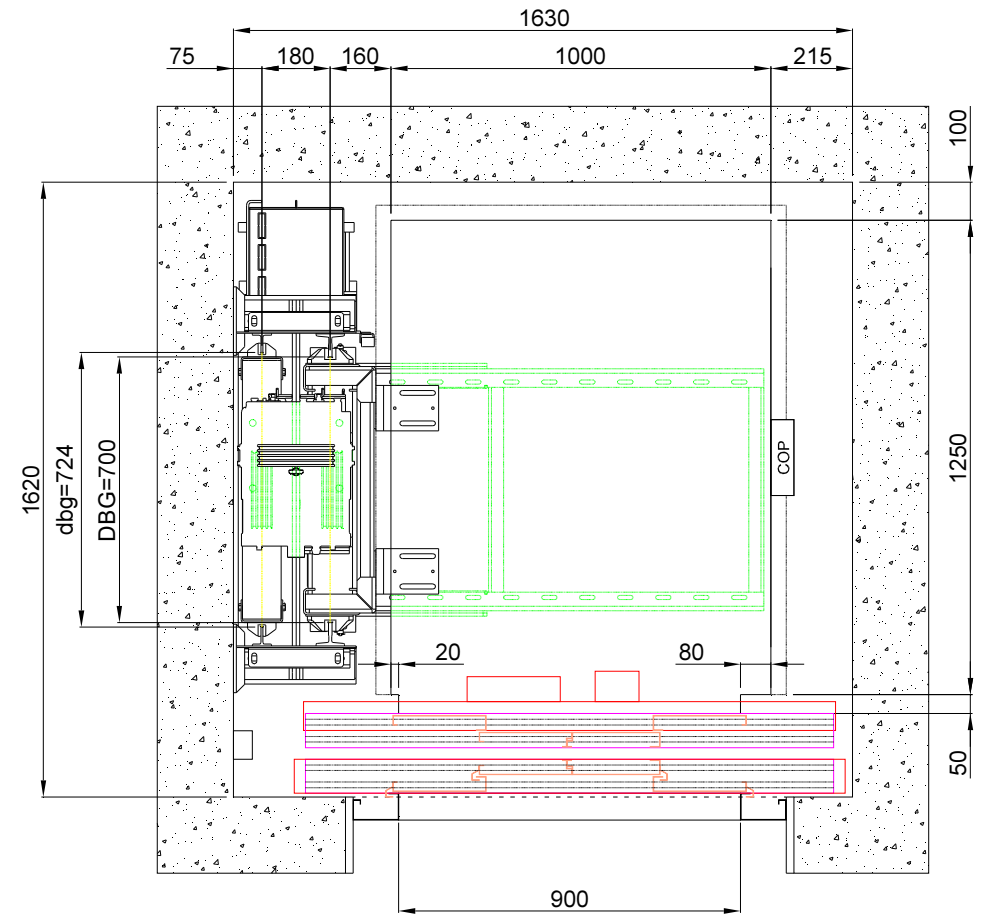
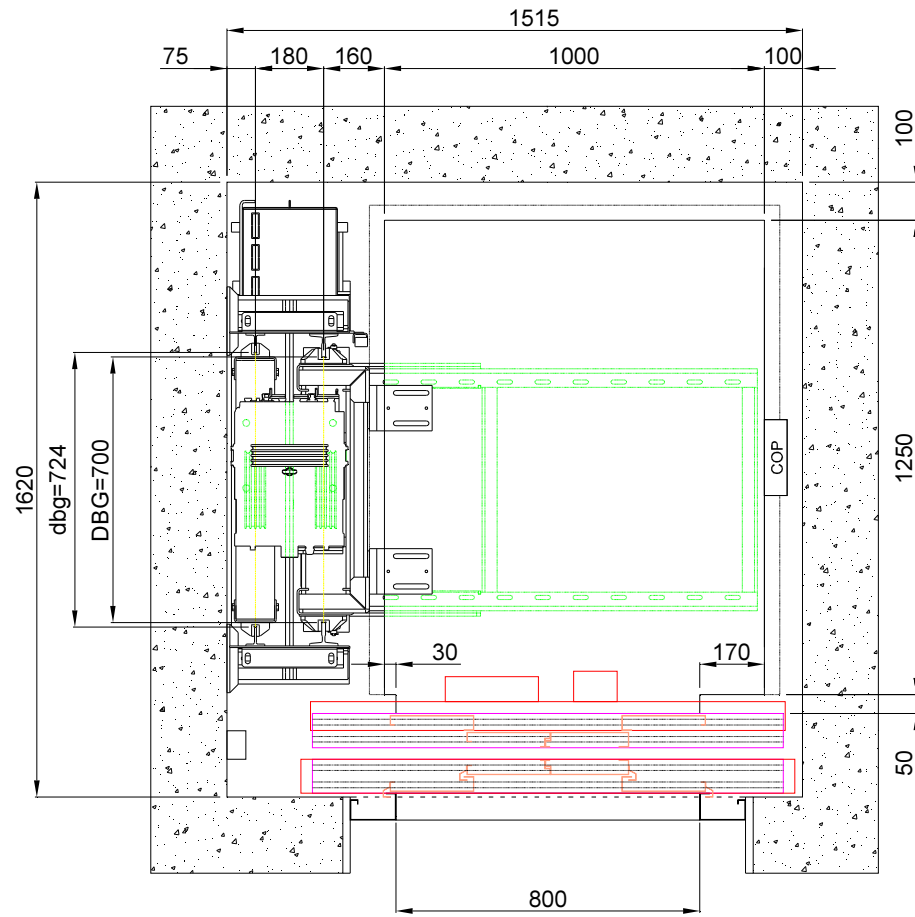

320Kg - 1000x1250mm - 4 panel center opening

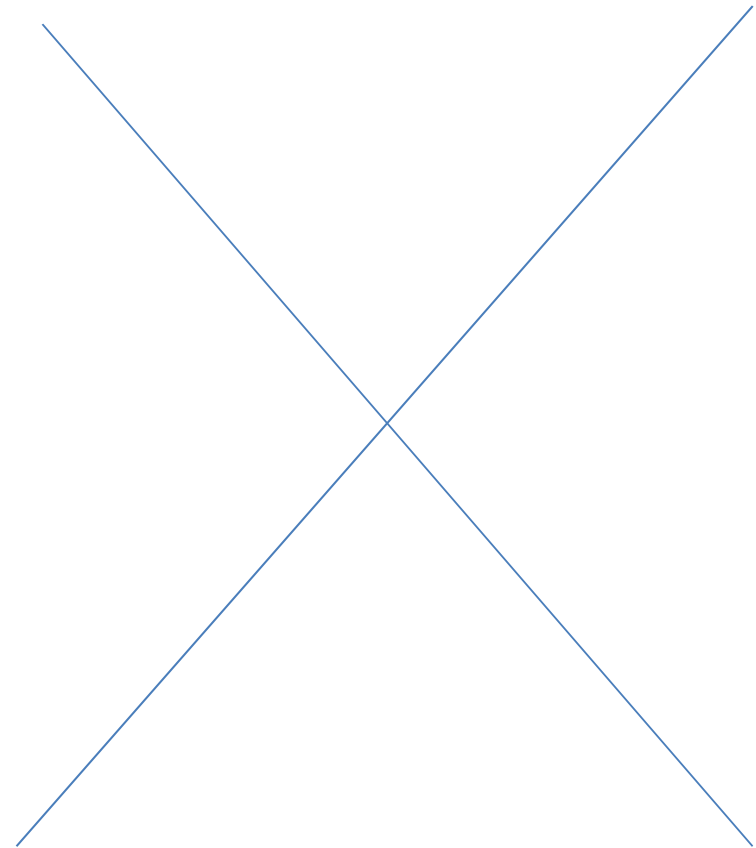
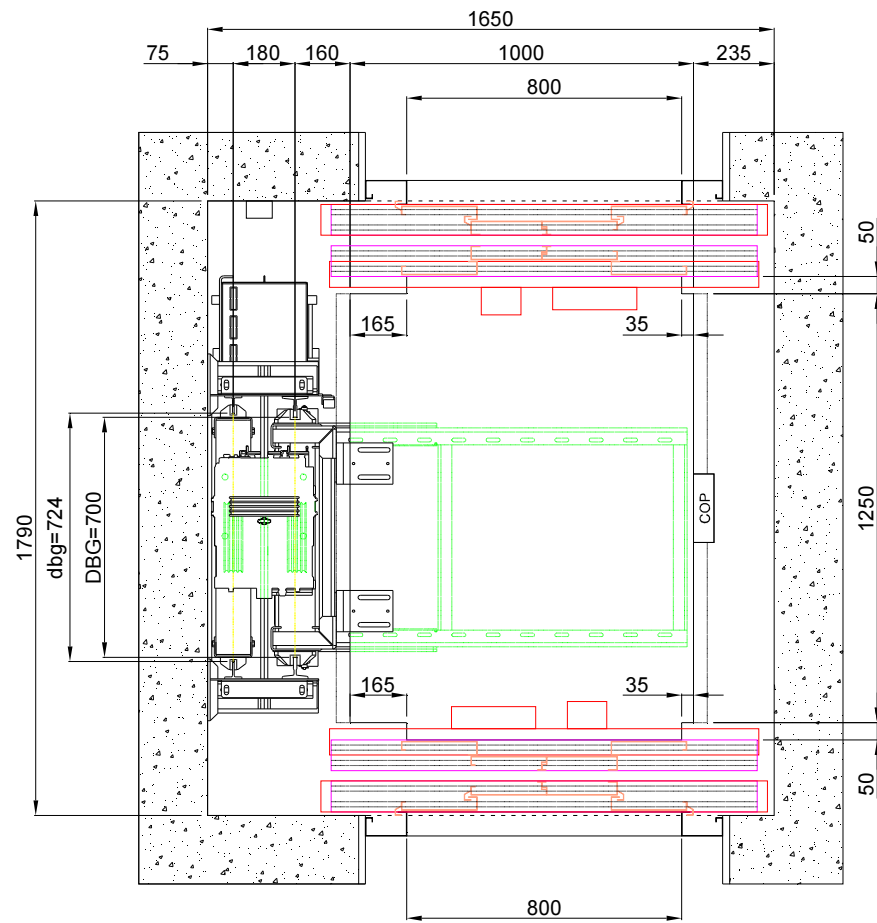

320Kg - 1000x1250mm - 4 panel center opening

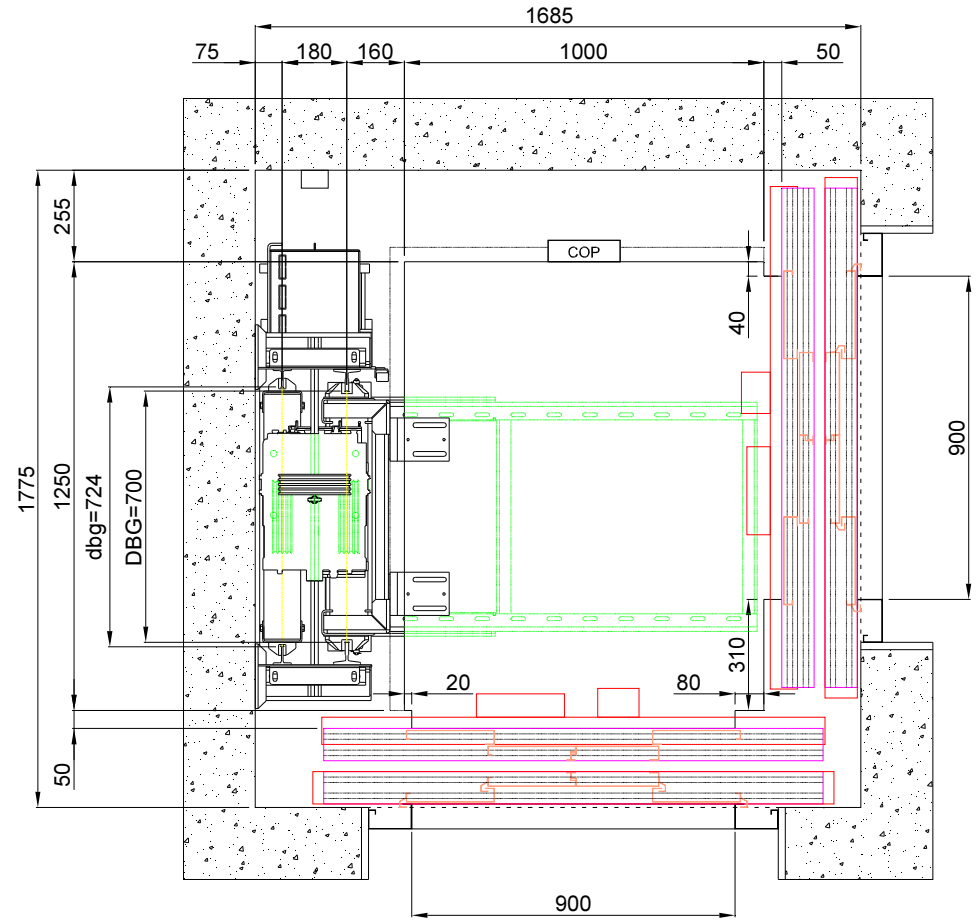
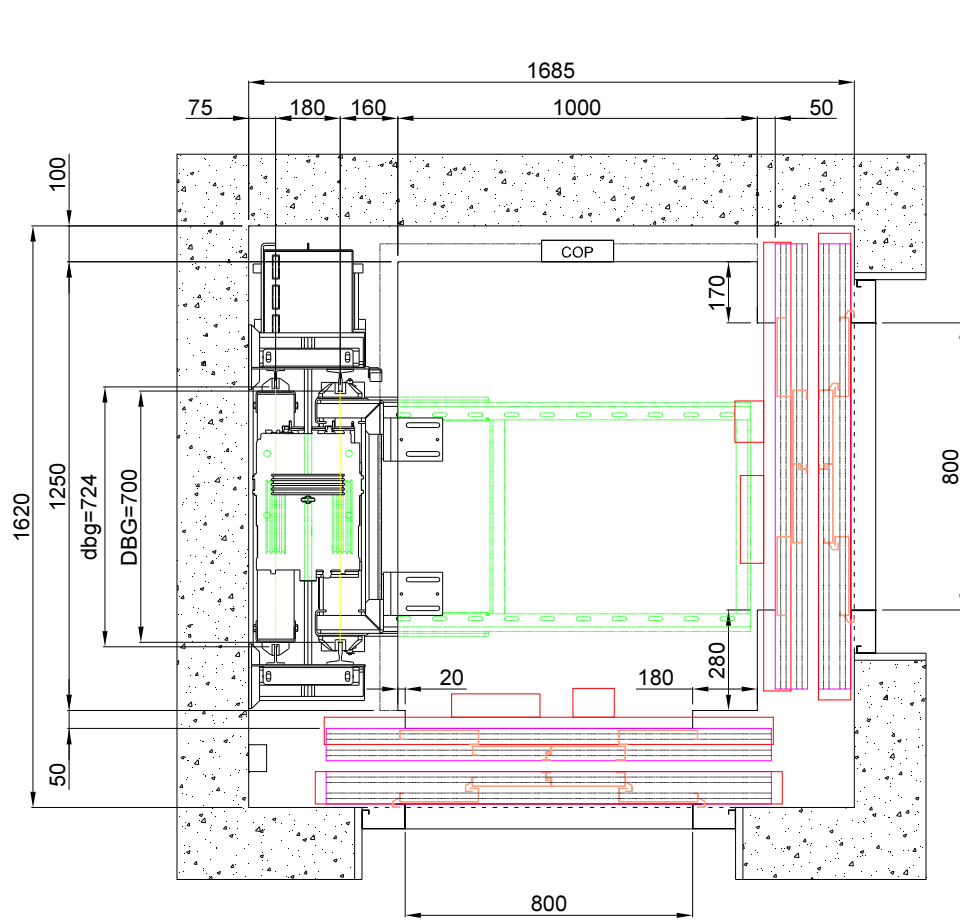

320Kg - 1250x1000mm - 4 panel center opening

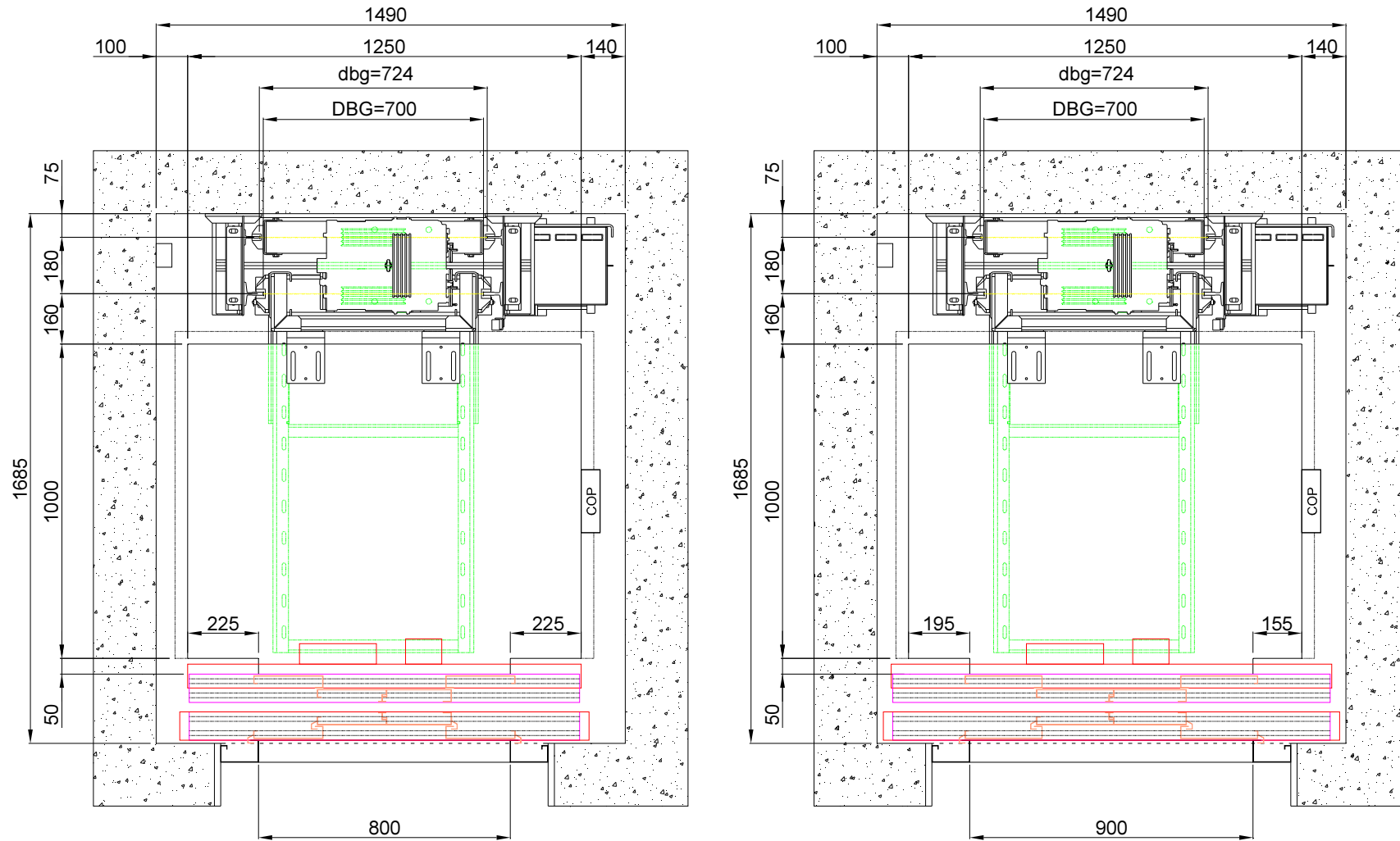

320Kg - 1000x1250mm - semi automatic with bus

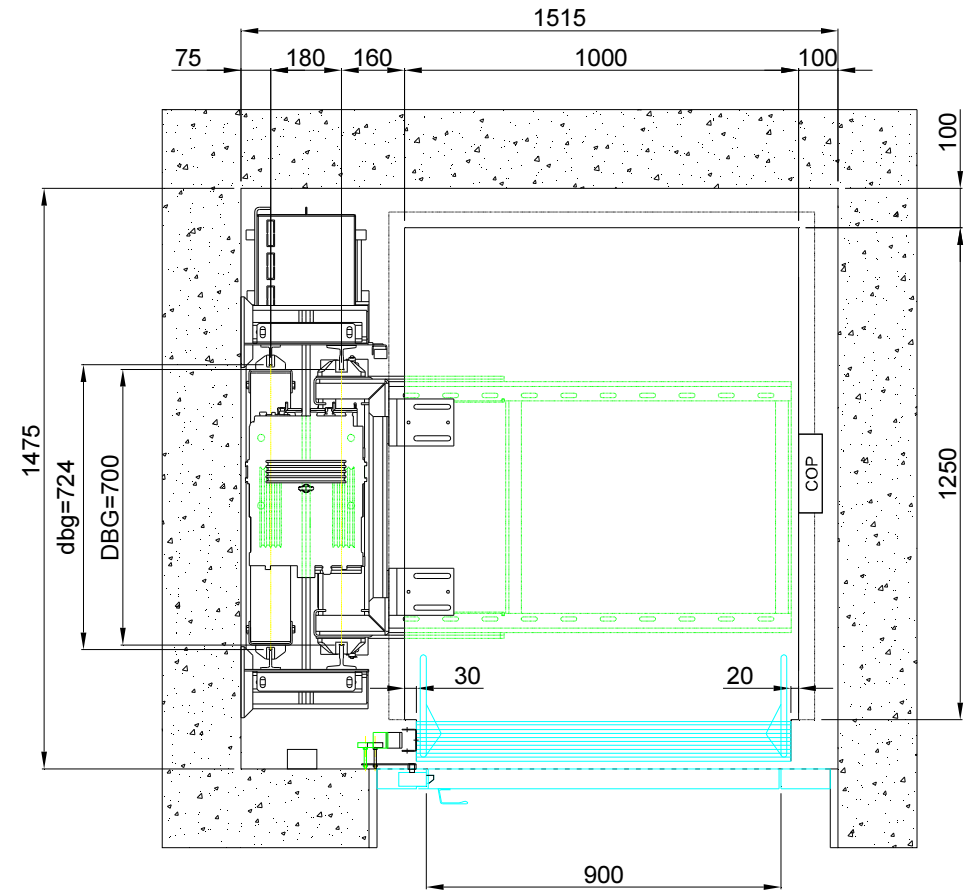
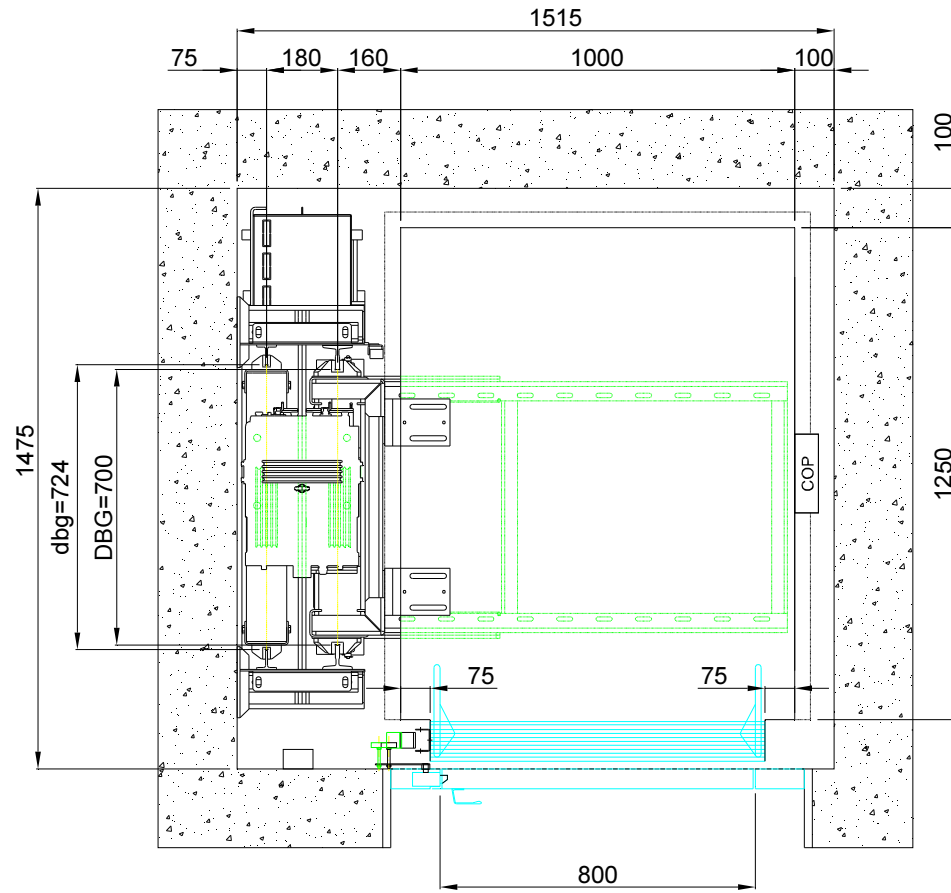

320Kg - 1000x1250mm - semi automatic with bus

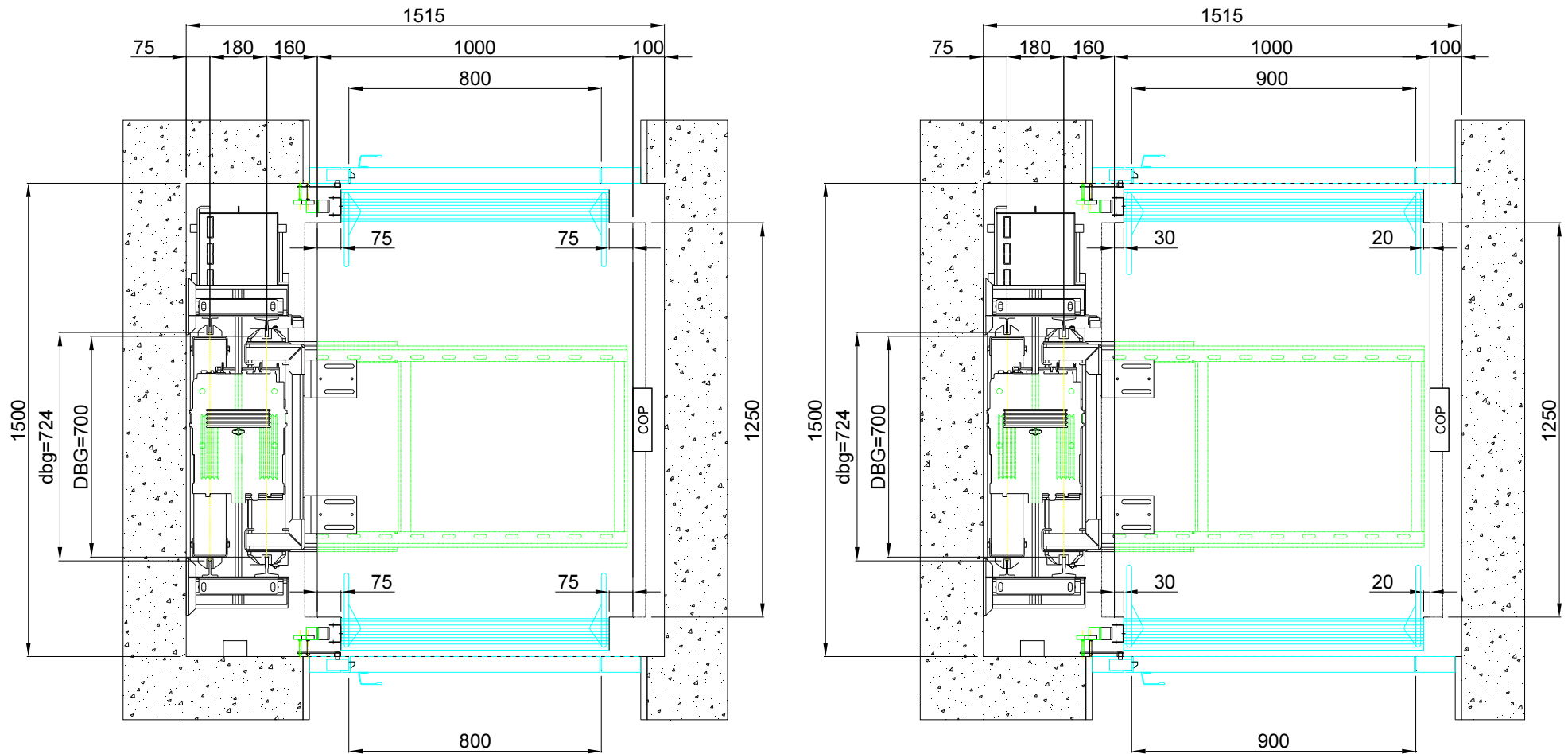

320Kg - 1000x1250mm - semi automatic with bus

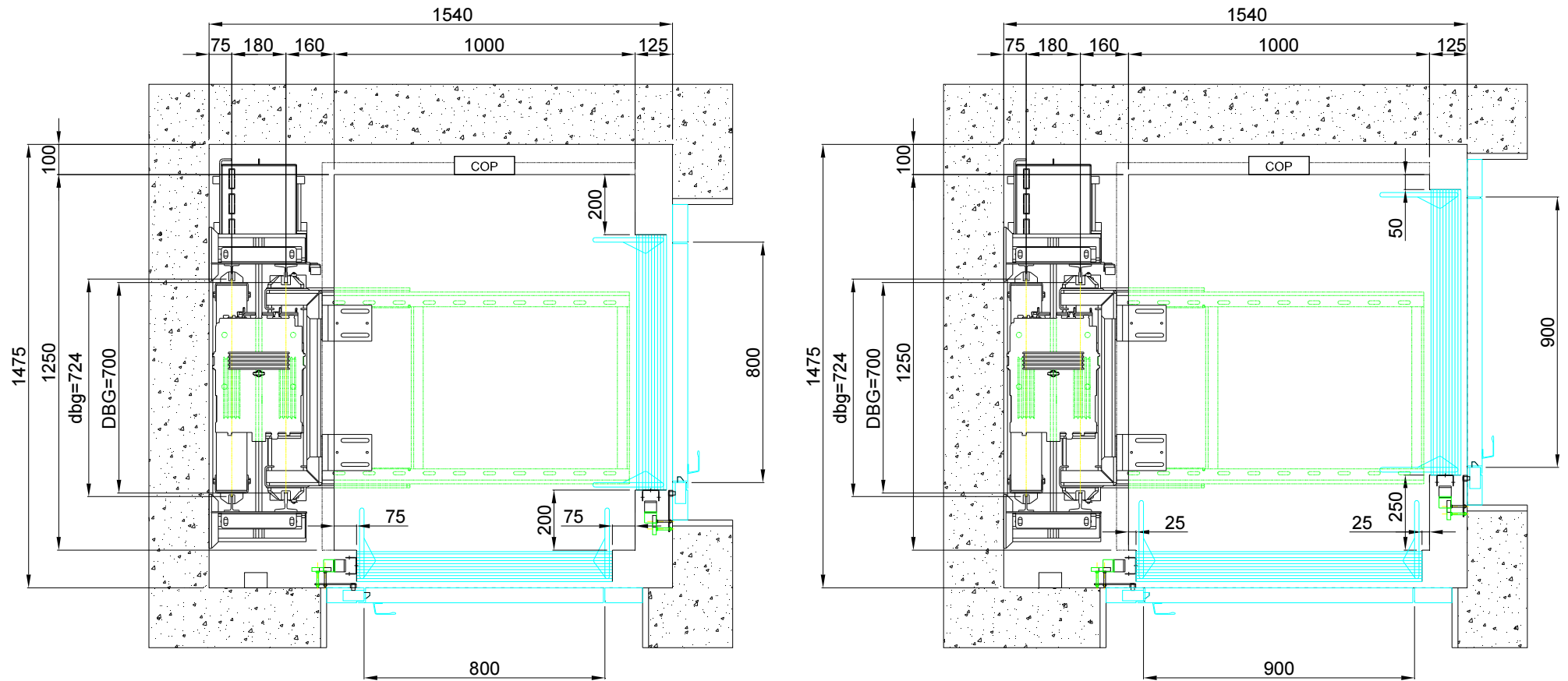

320Kg - 1250x1000mm - semi automatic with bus

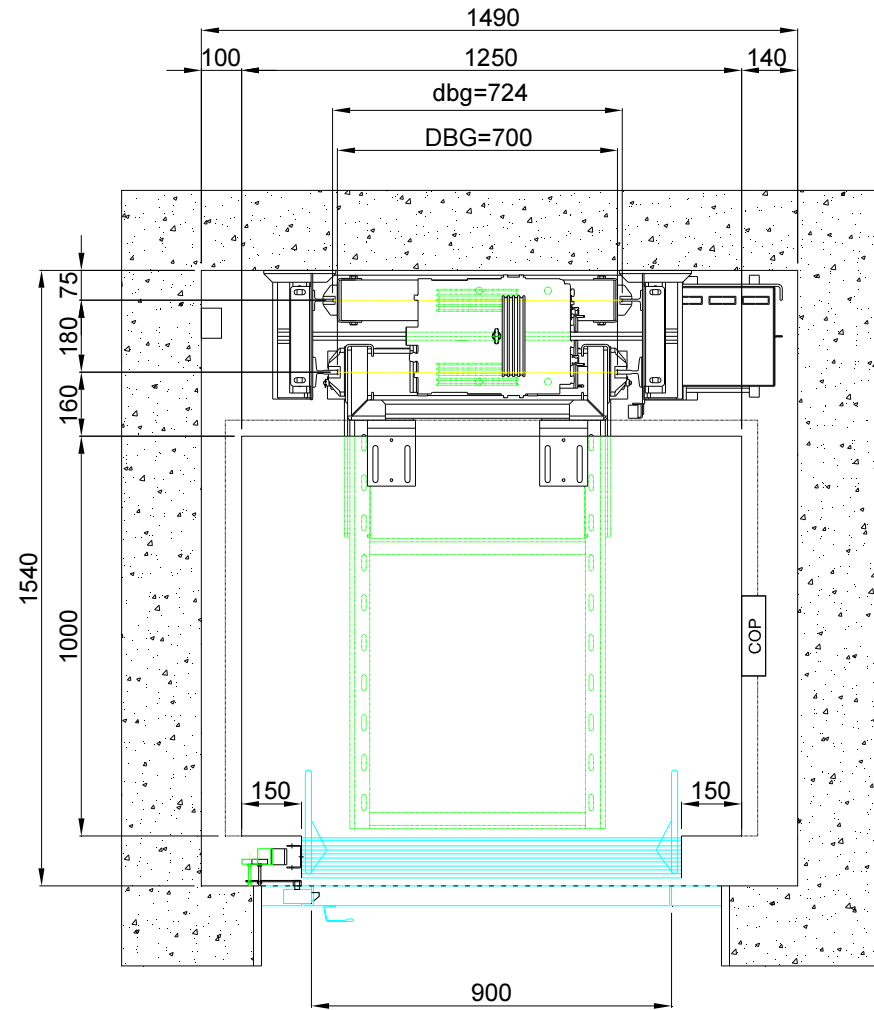
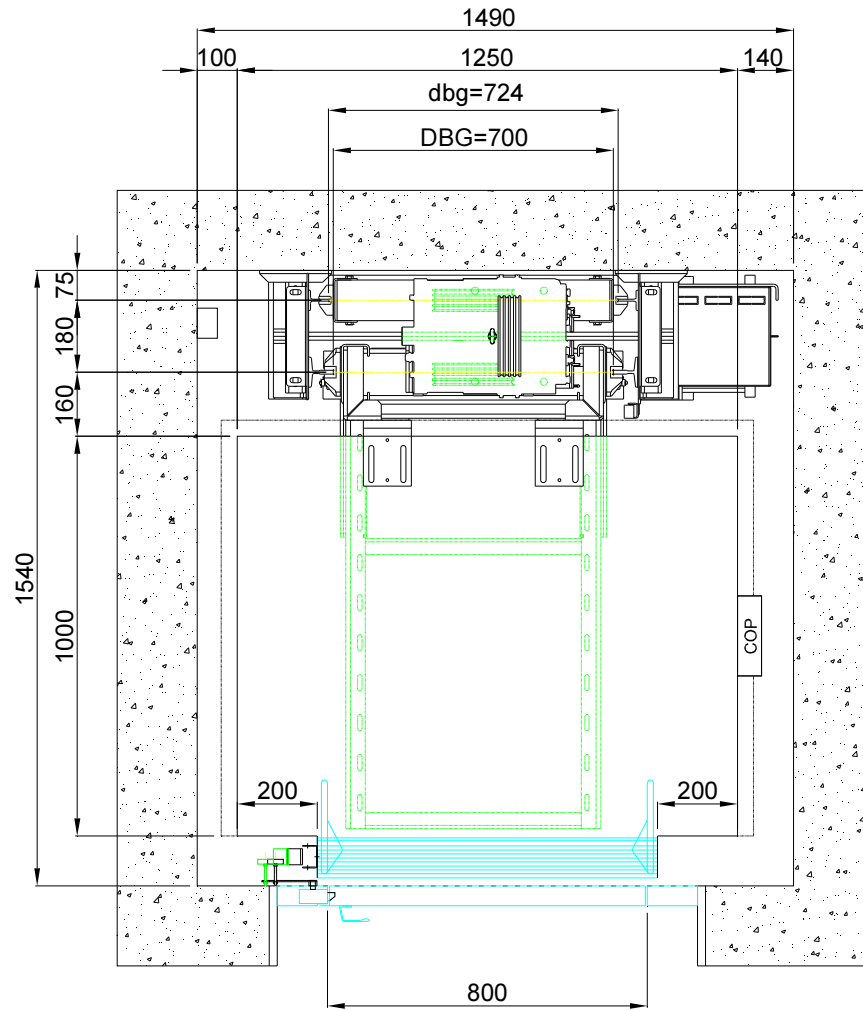

320Kg - 1000x1250mm - semi automatic with bus

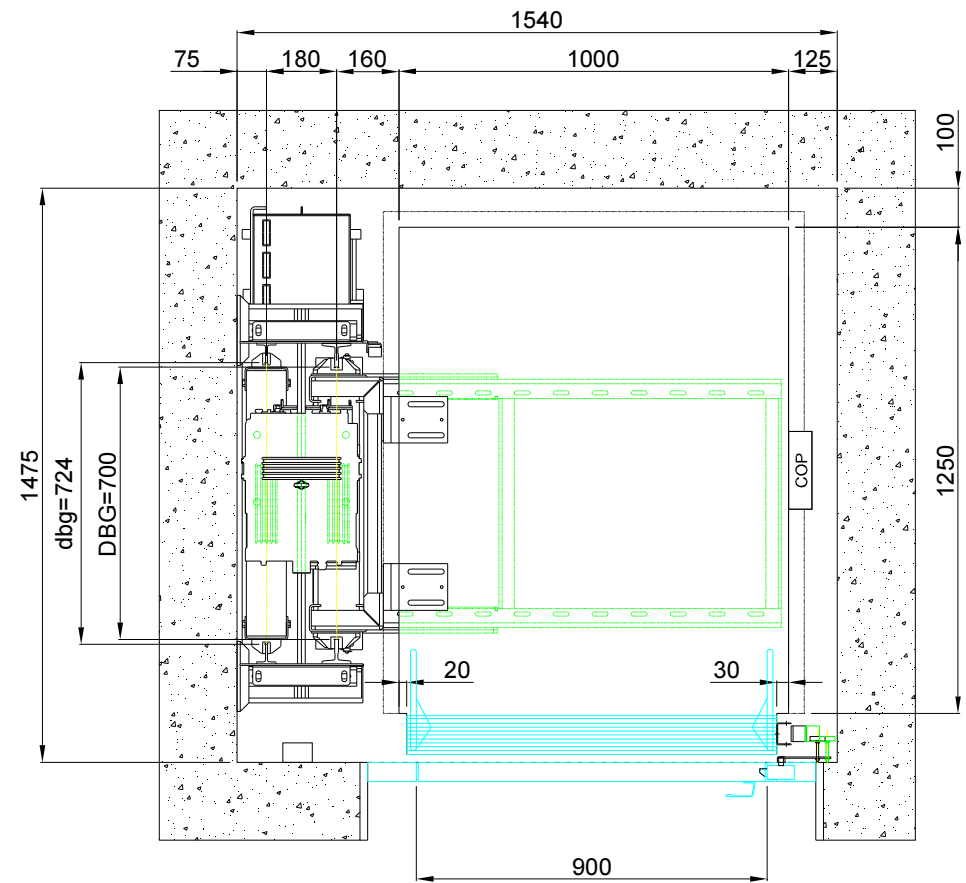
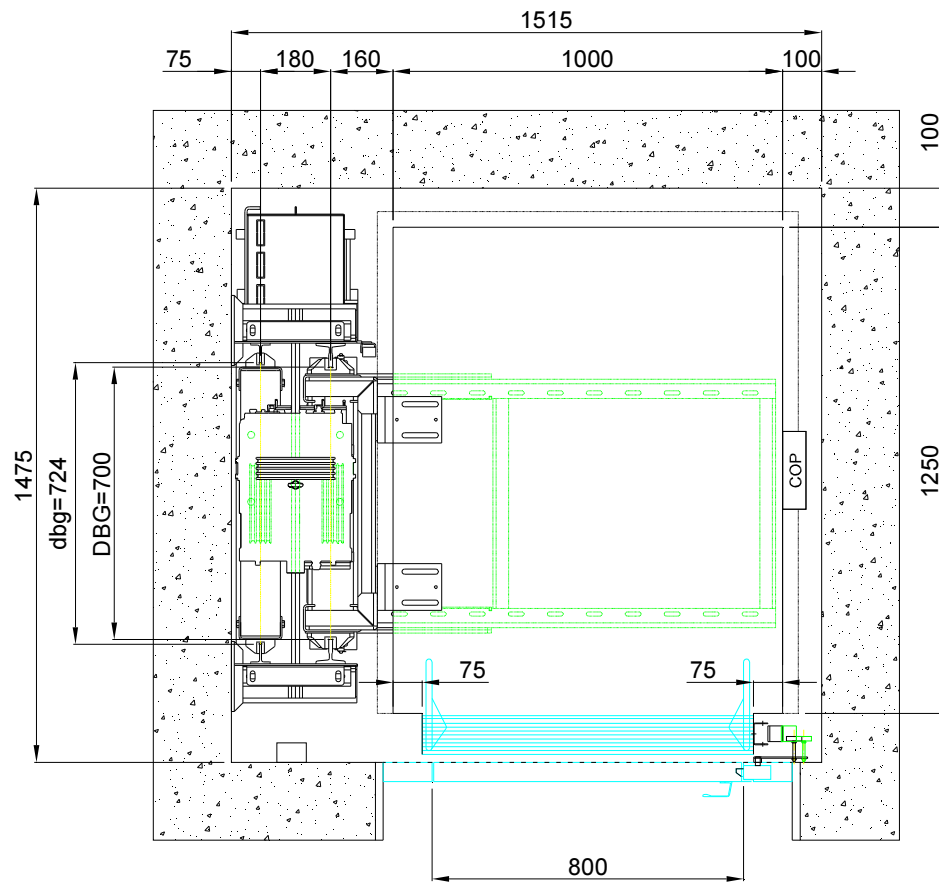

320Kg - 1000x1250mm - semi automatic with bus

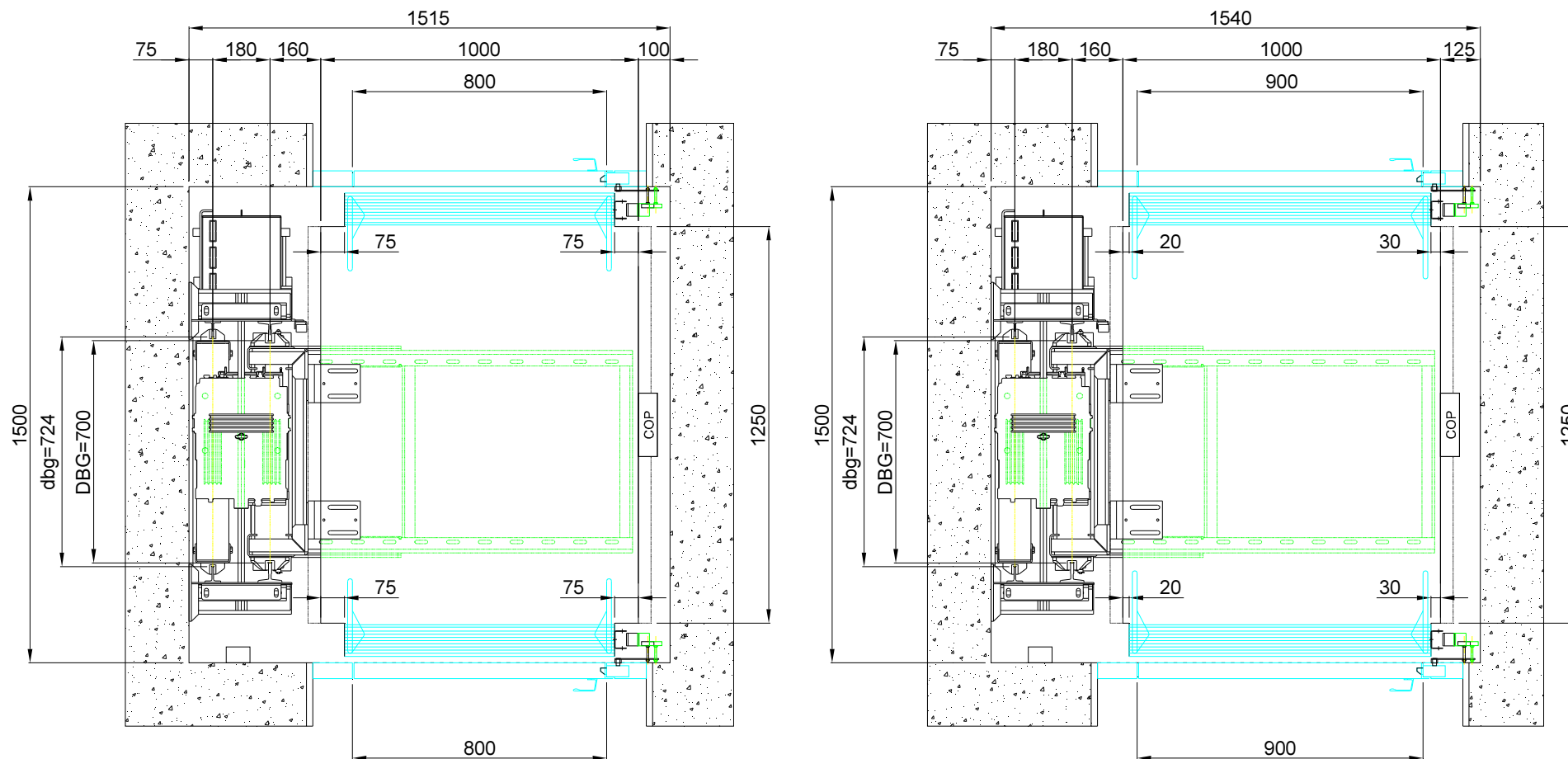

320Kg - 1000x1250mm - semi automatic with bus

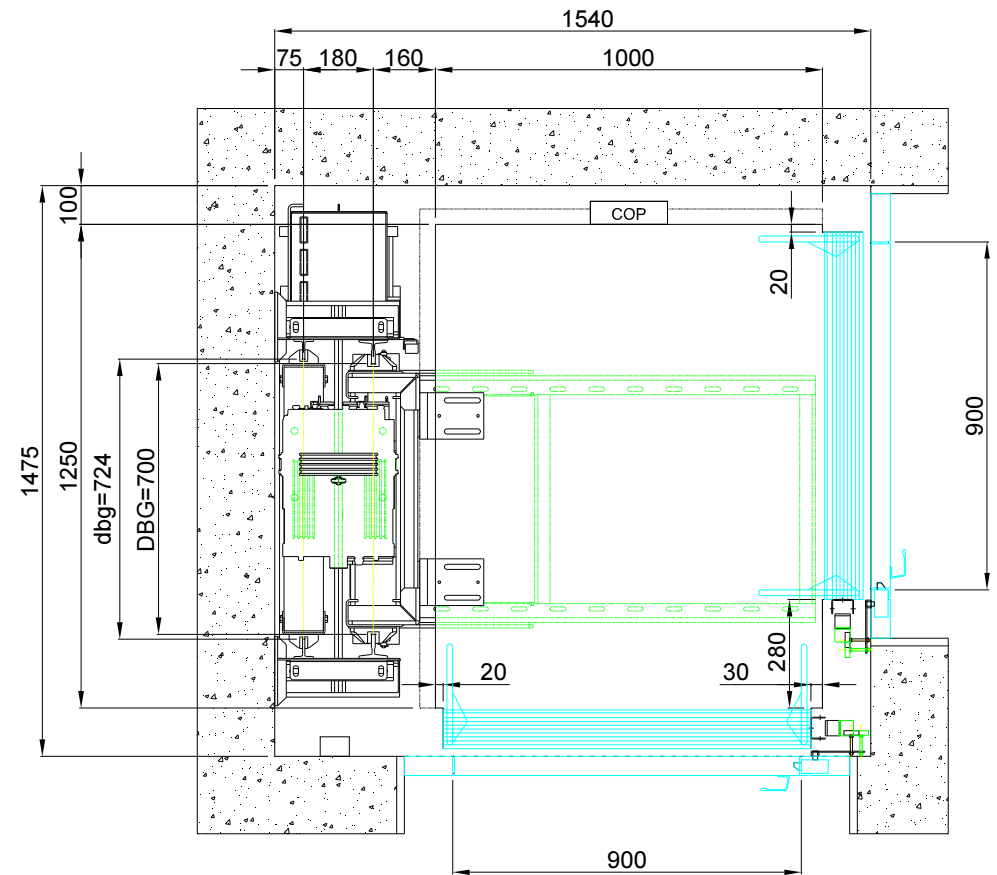
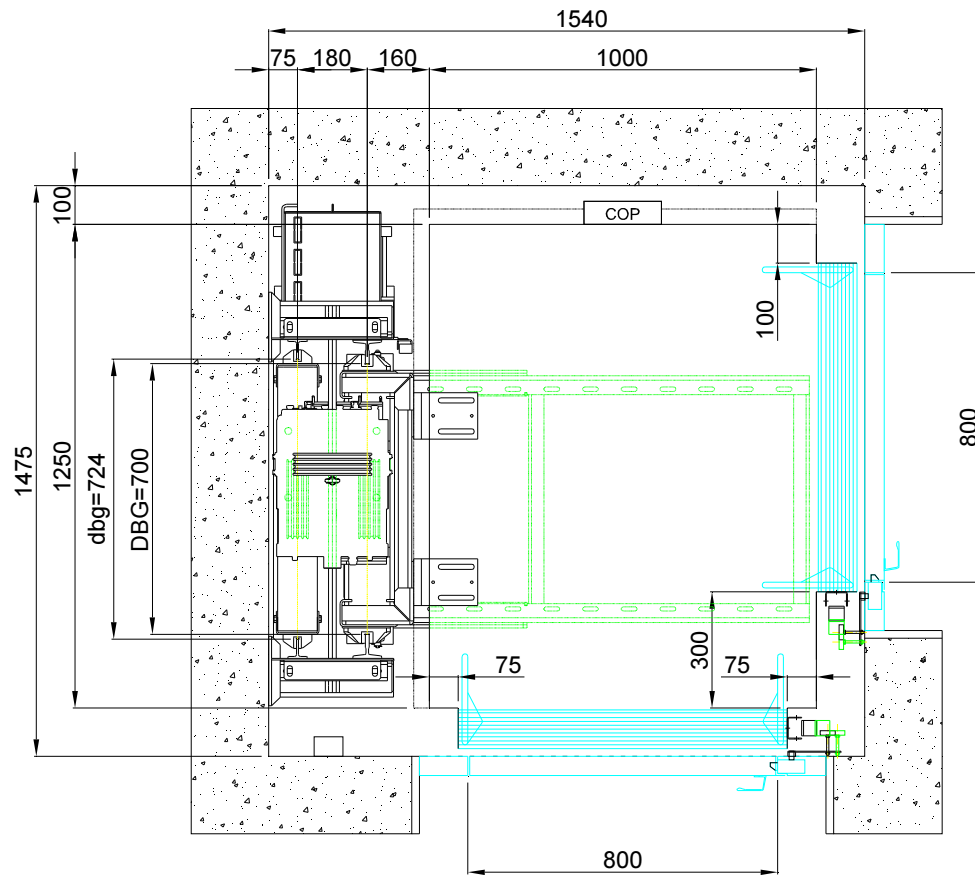

320Kg - 1250x1000mm - semi automatic with bus

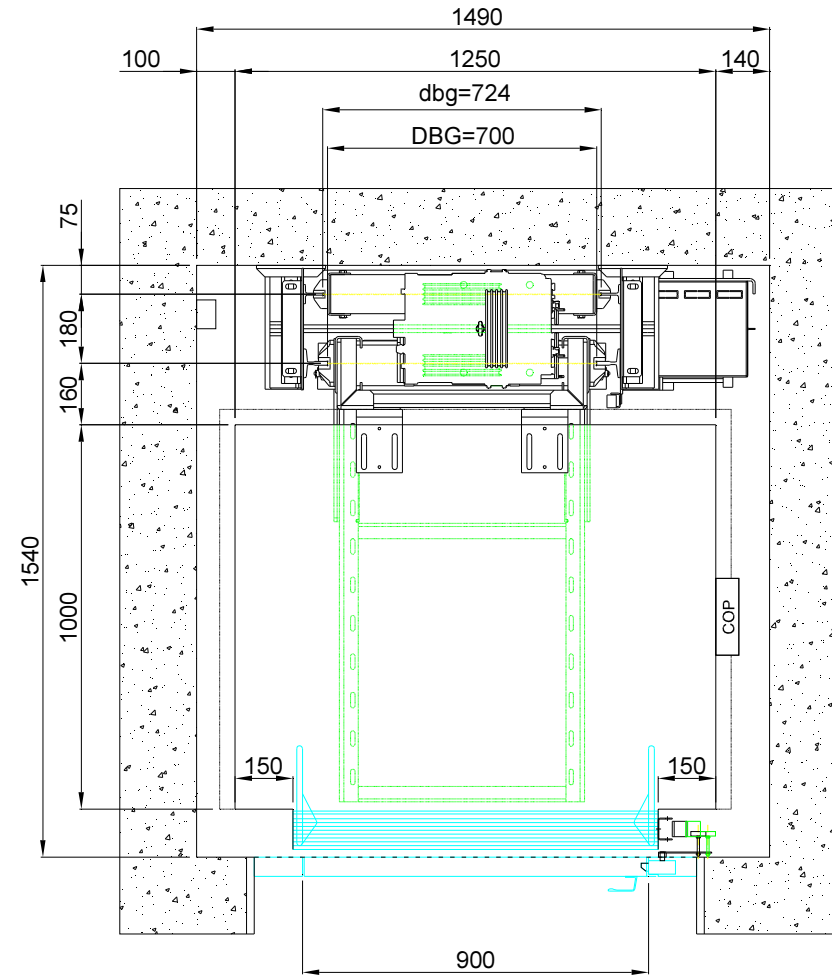
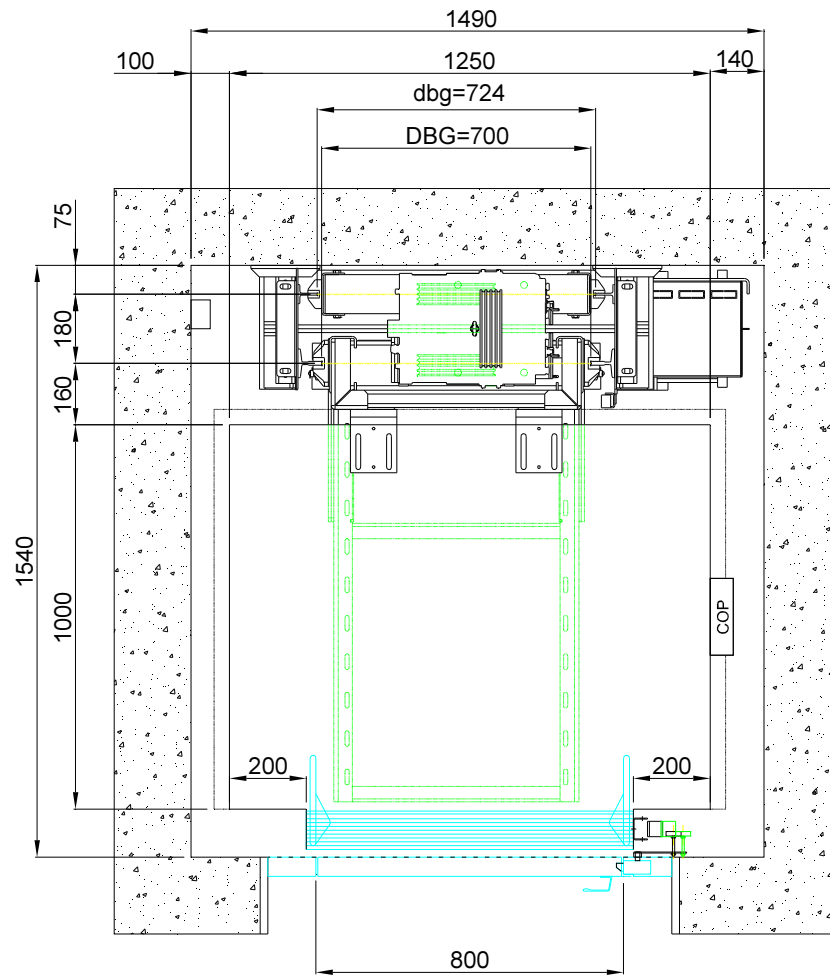

400Kg - 1100x1400mm - 2 panel side opening

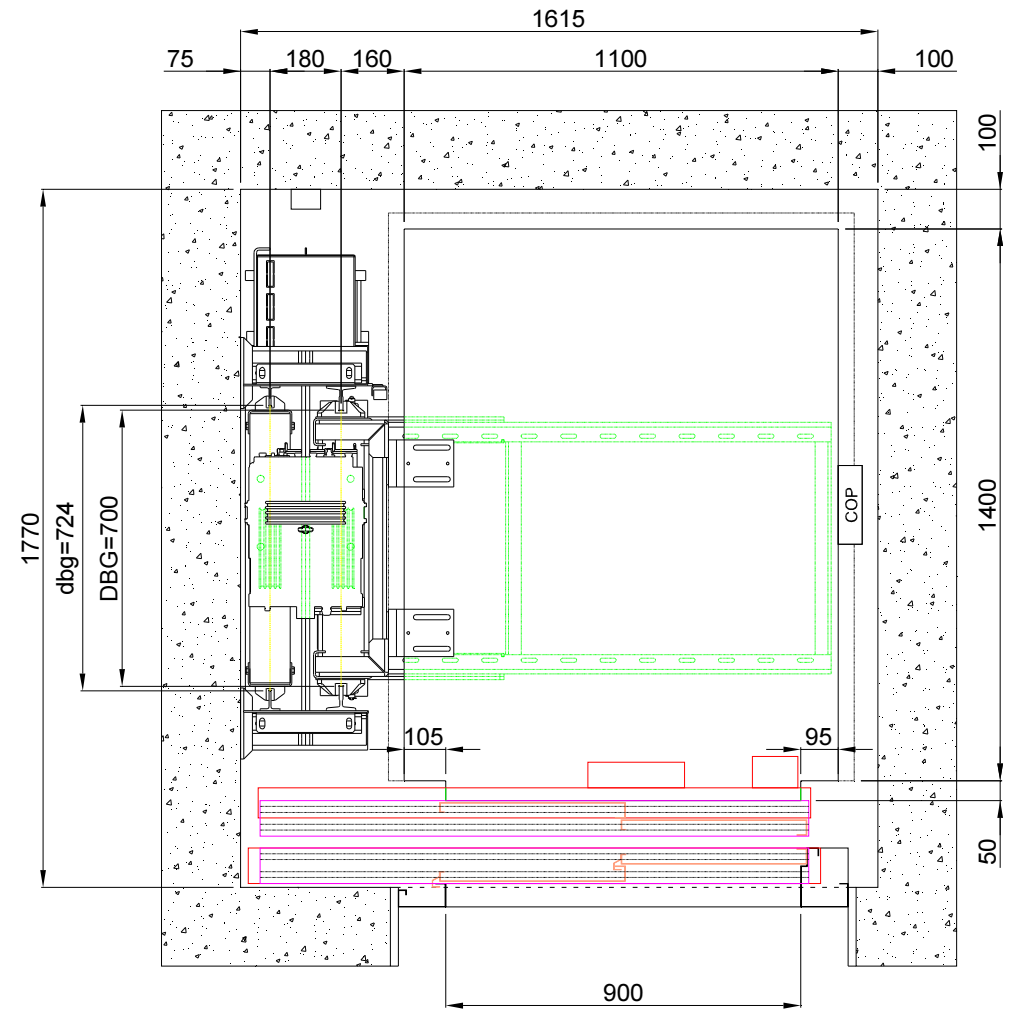
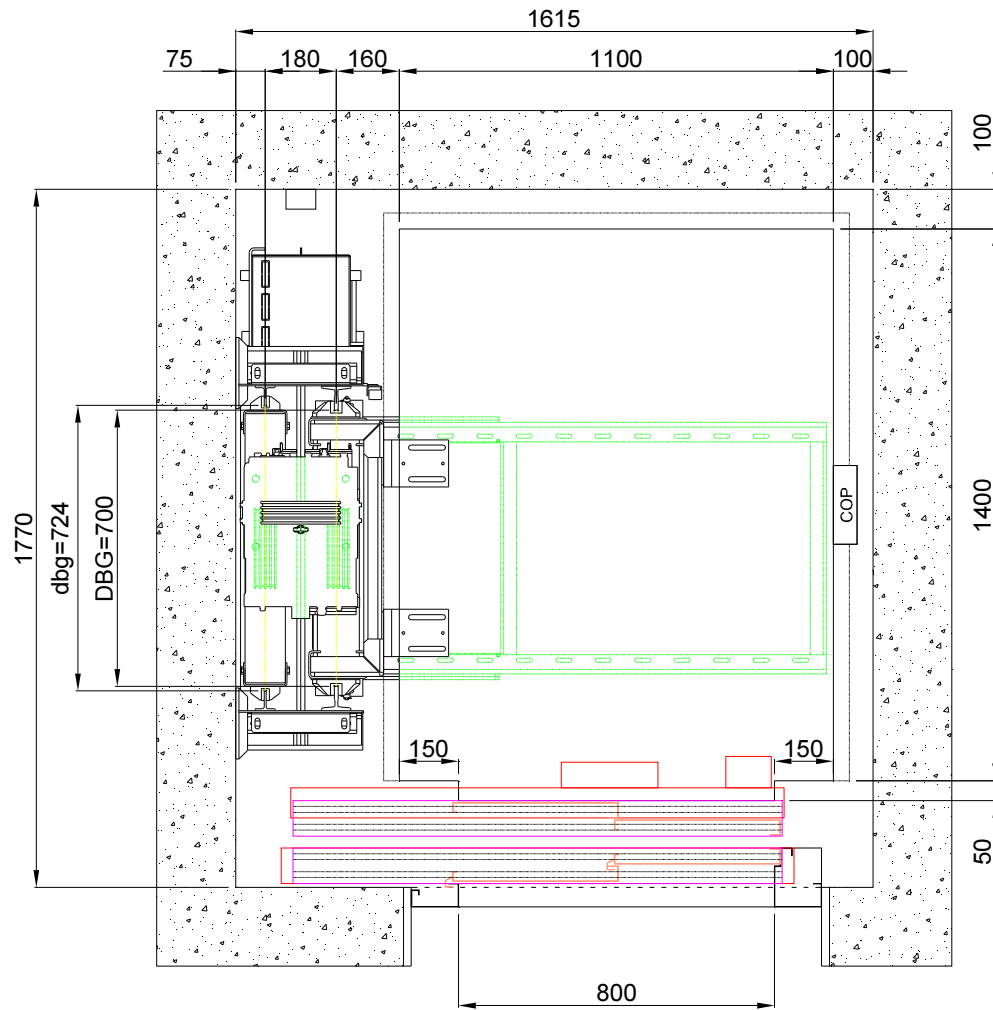

400Kg - 1100x1400mm - 2 panel side opening

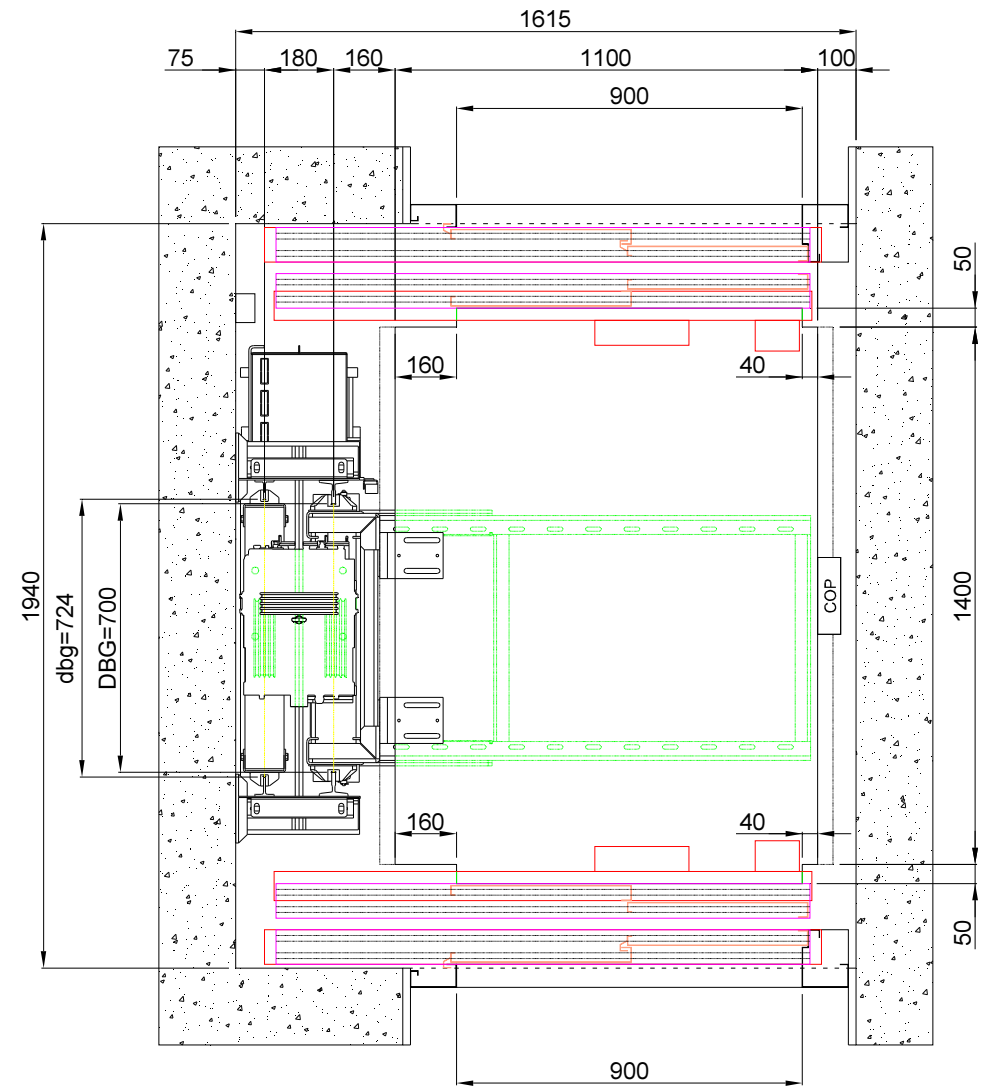
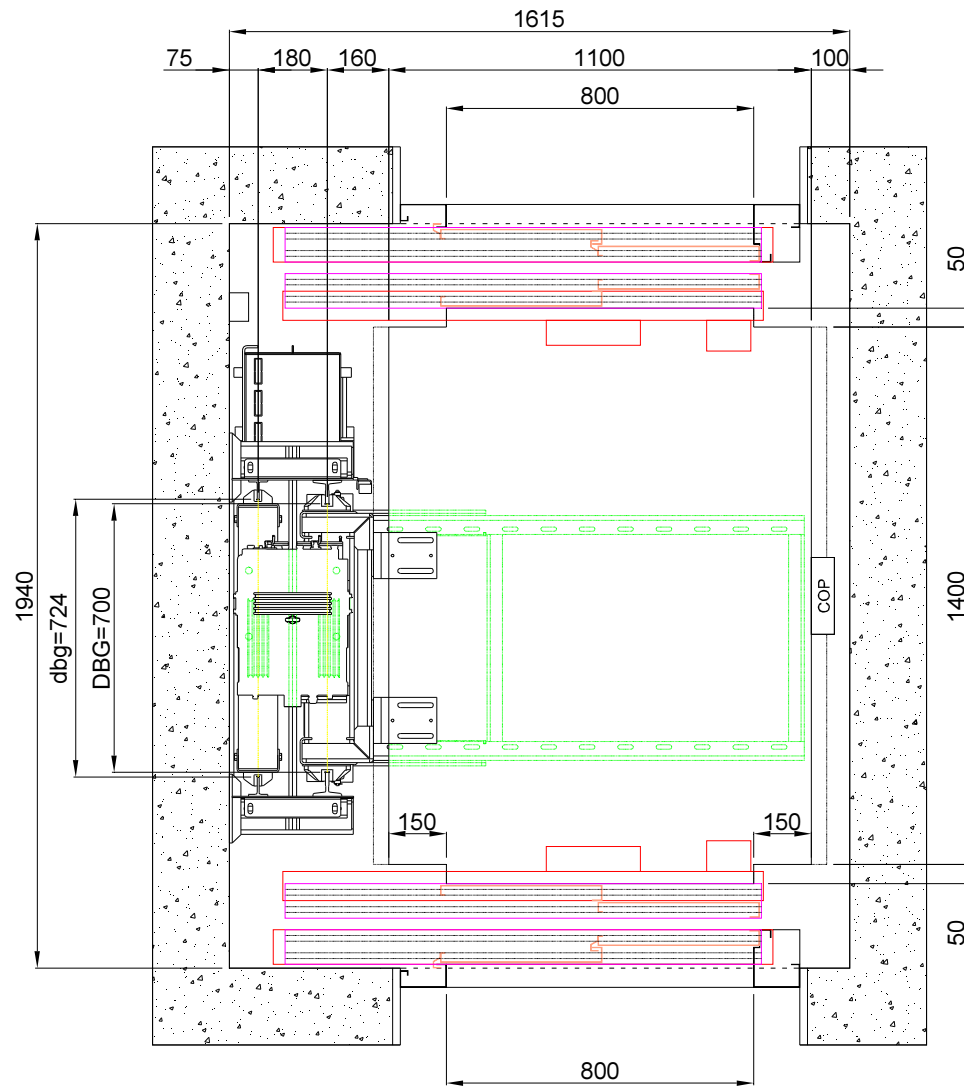

400Kg - 1100x1400mm - 2 panel side opening

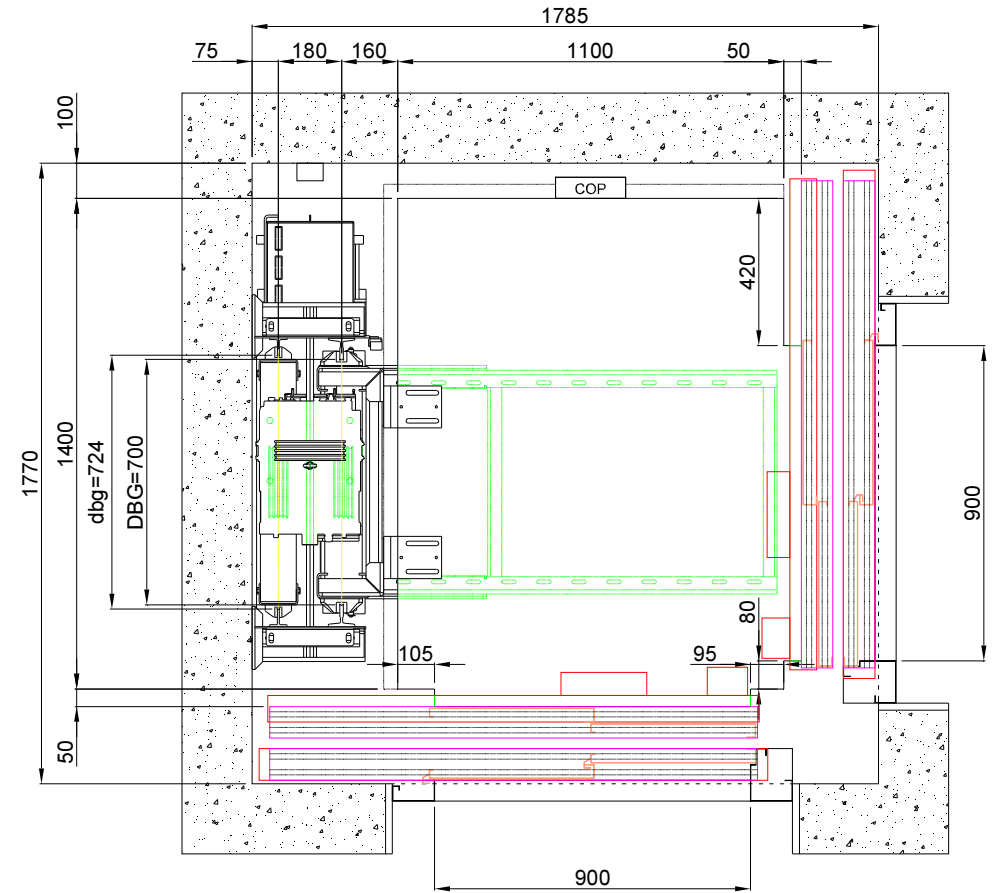
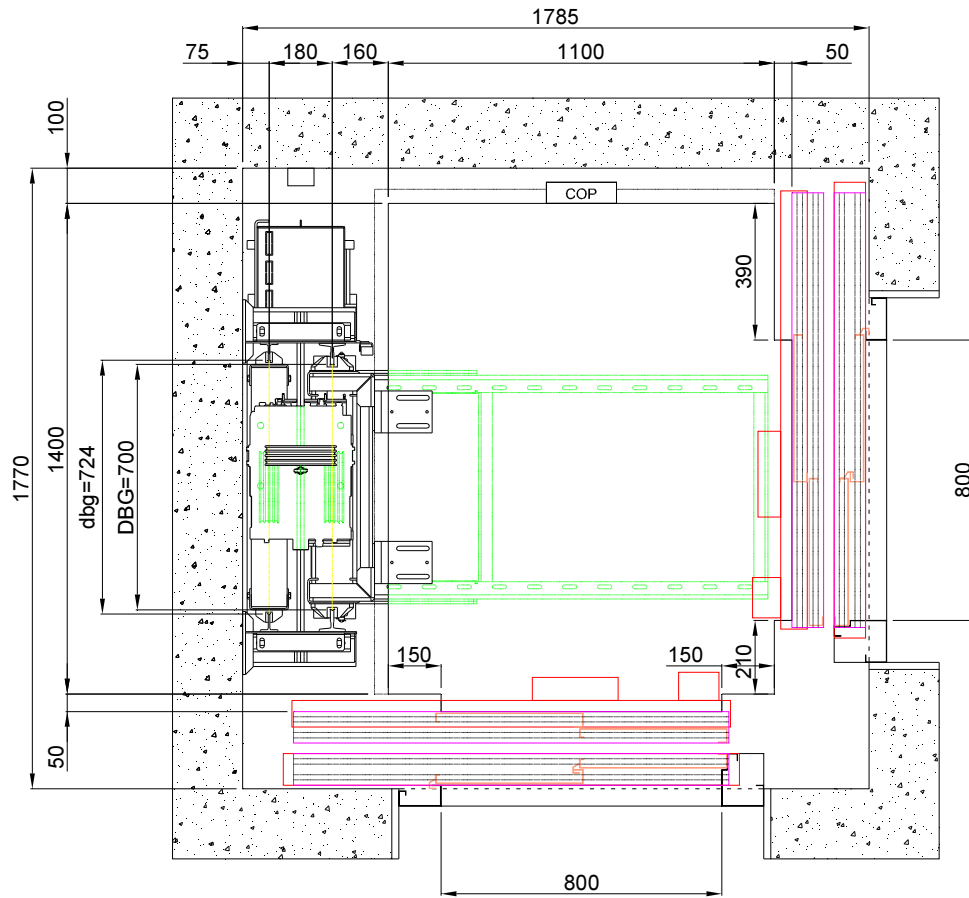

400Kg - 1400x1100mm - 2 panel side opening

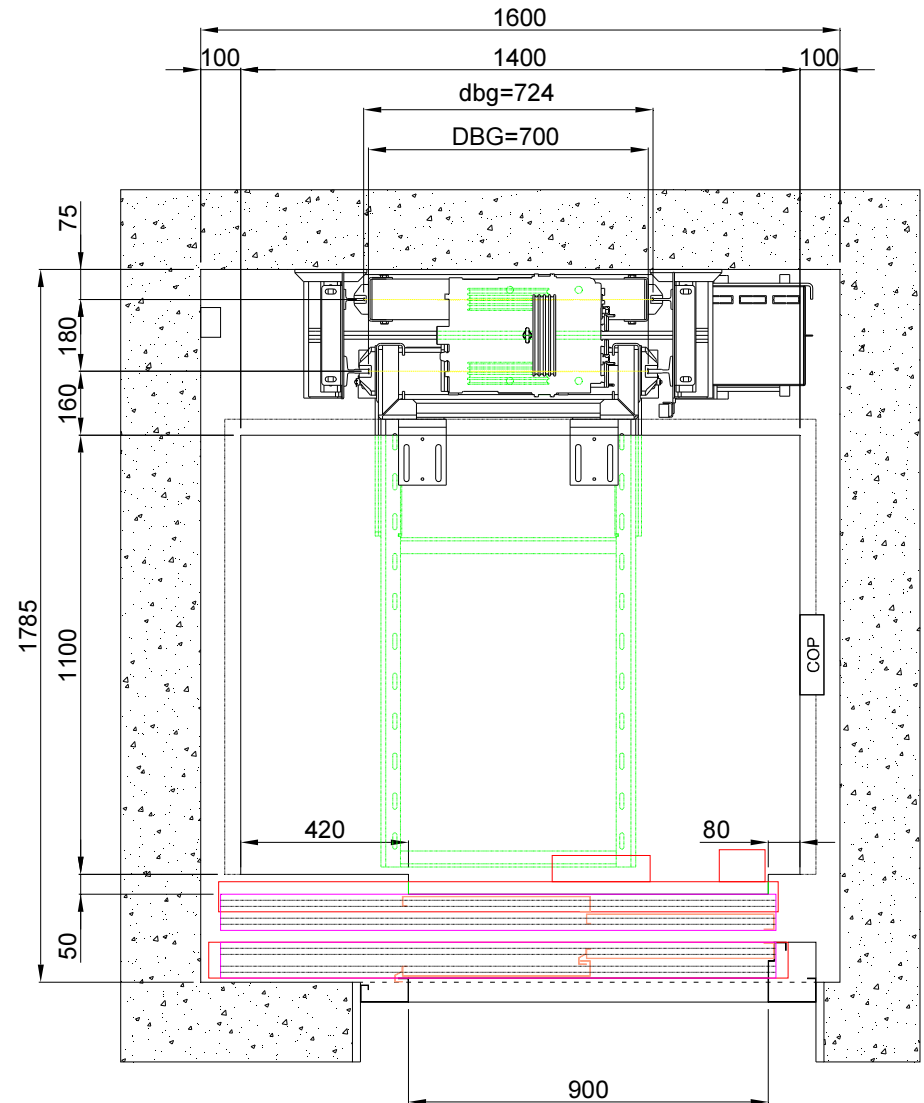
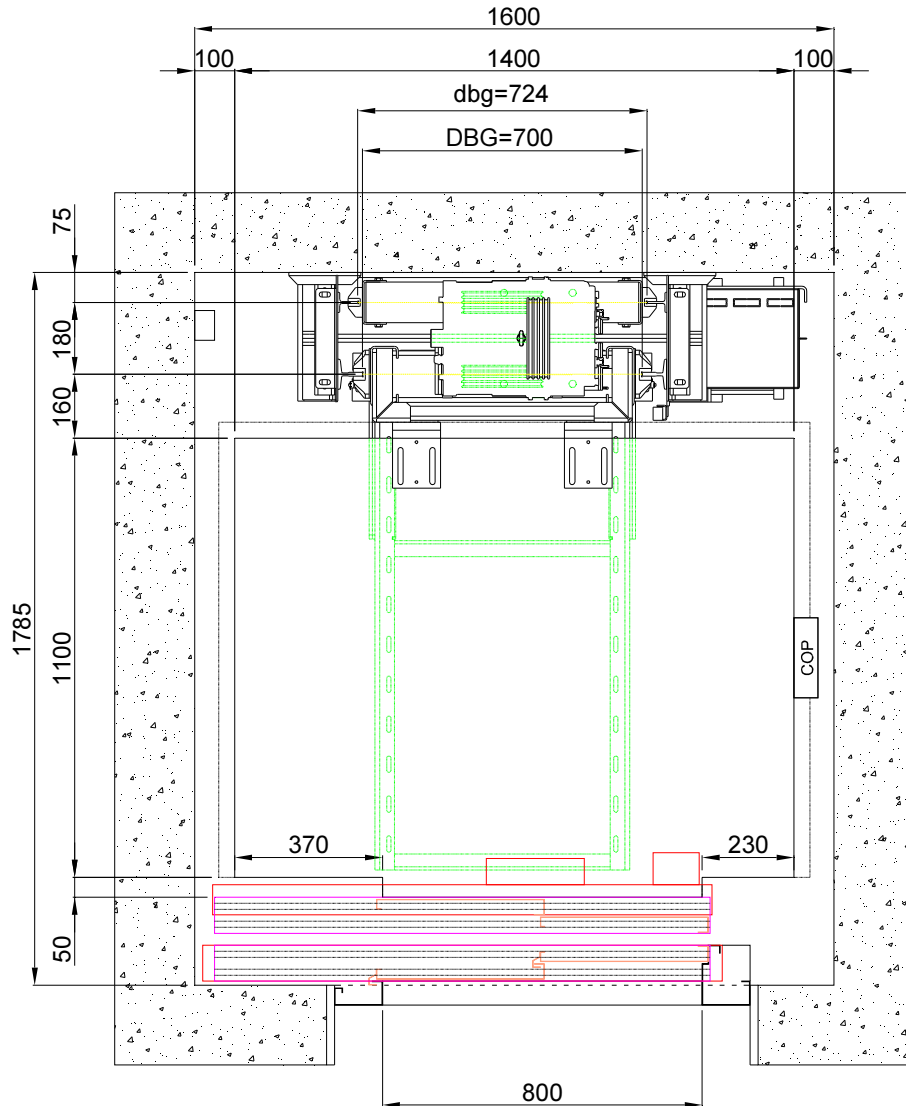

400Kg - 1100x1400mm - 2 panel center opening

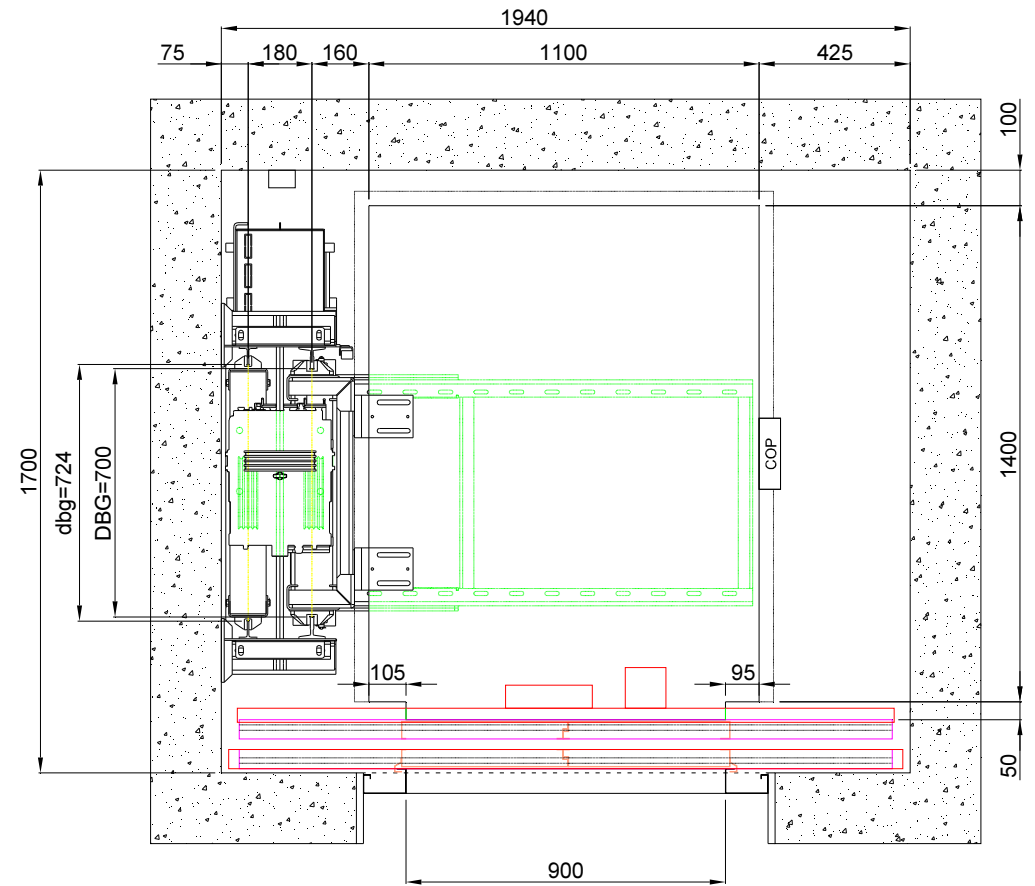
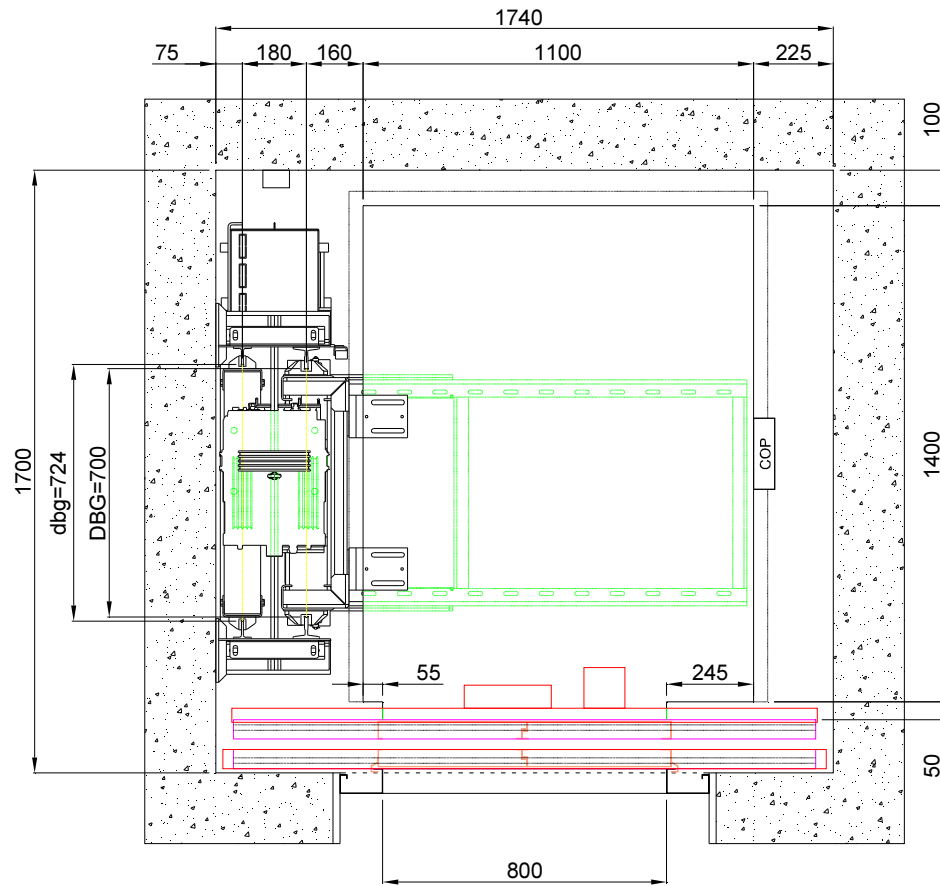

400Kg - 1100x1400mm - 2 panel center opening

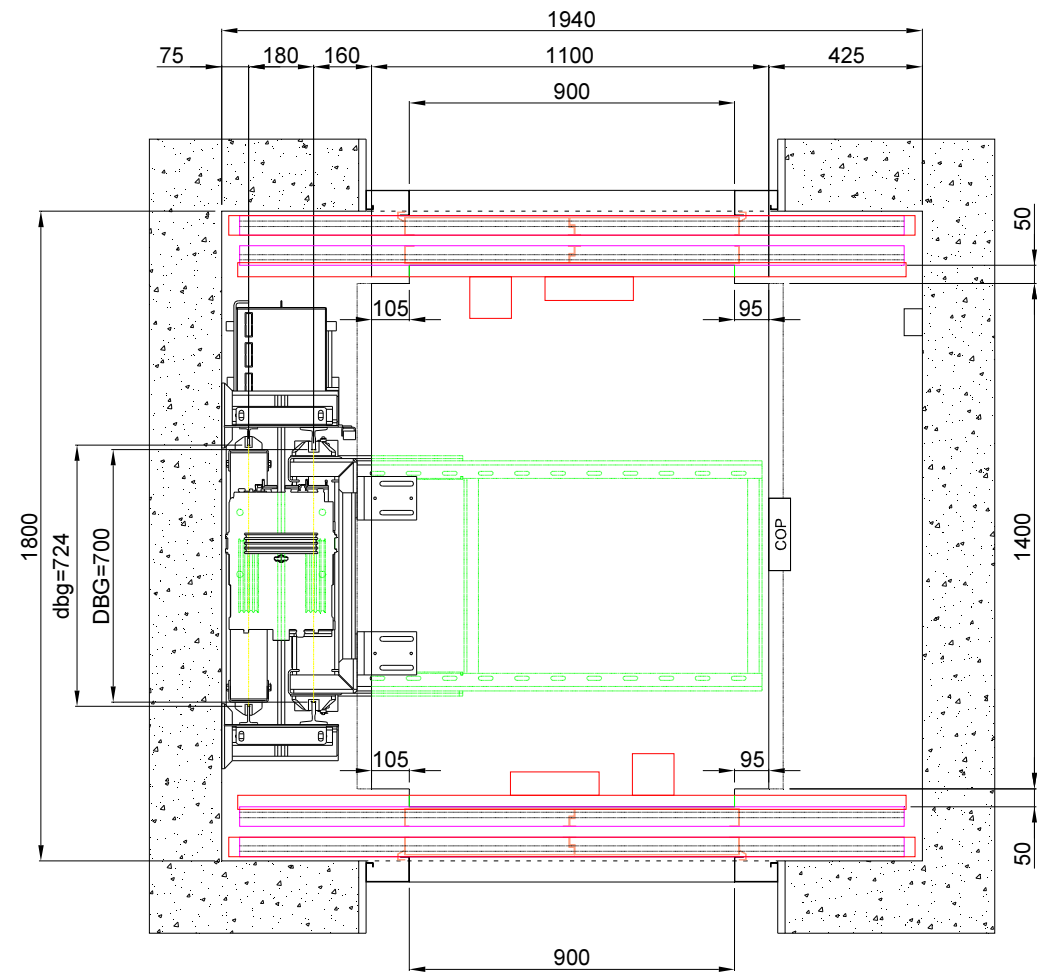
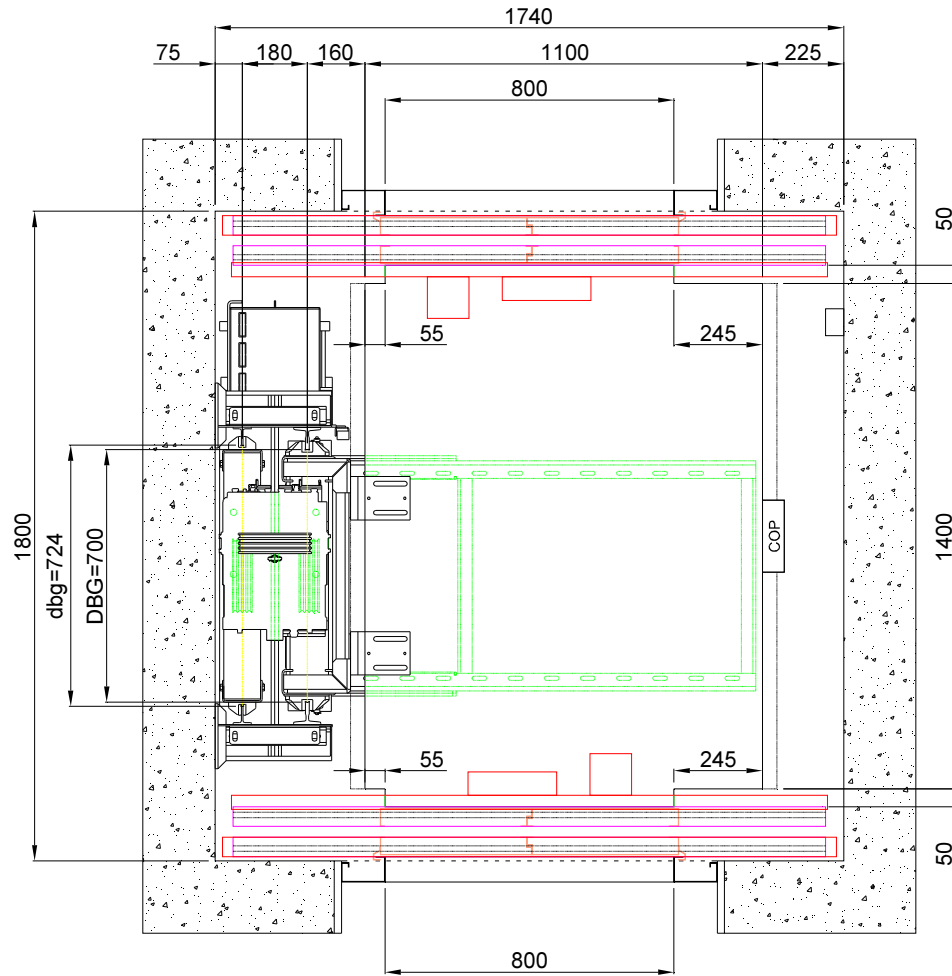

400Kg - 1400x1100mm - 2 panel center opening

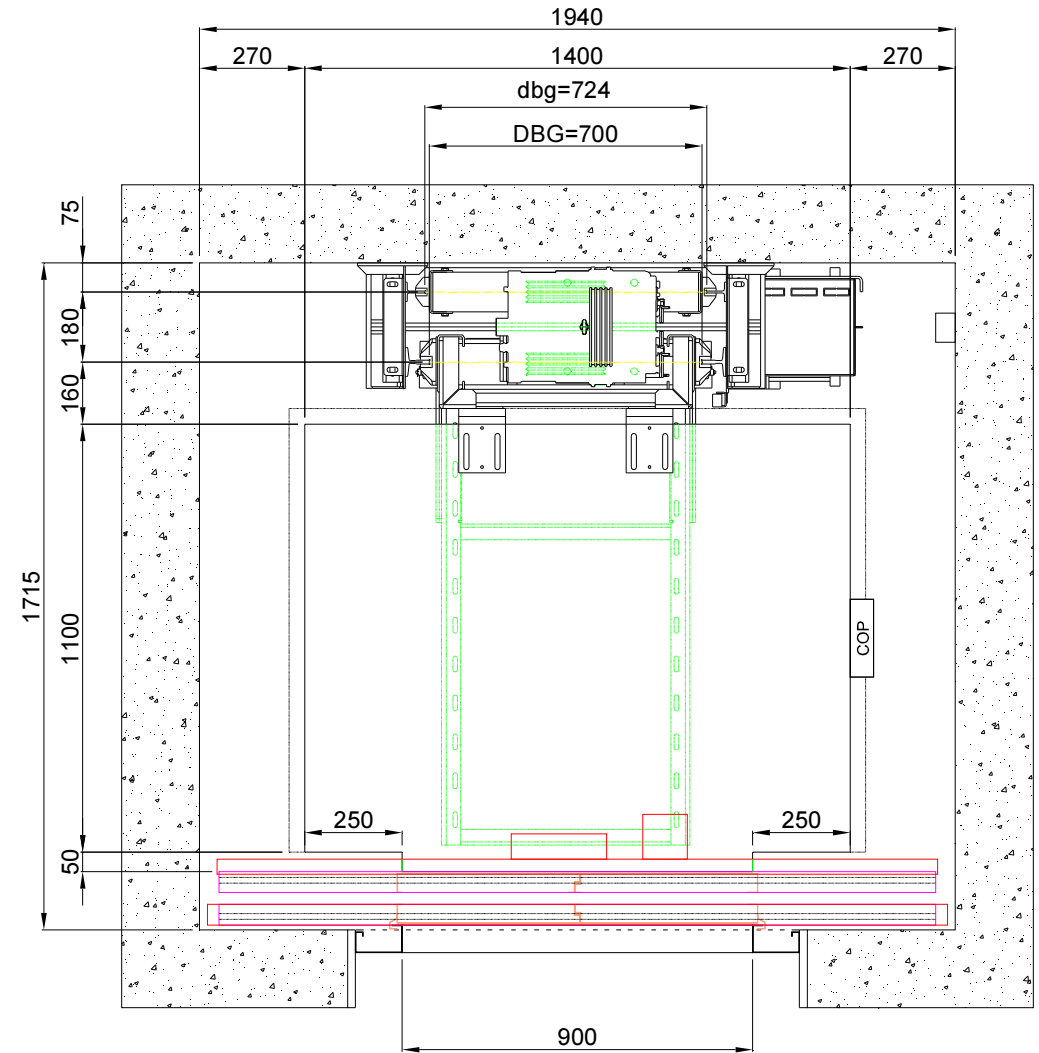
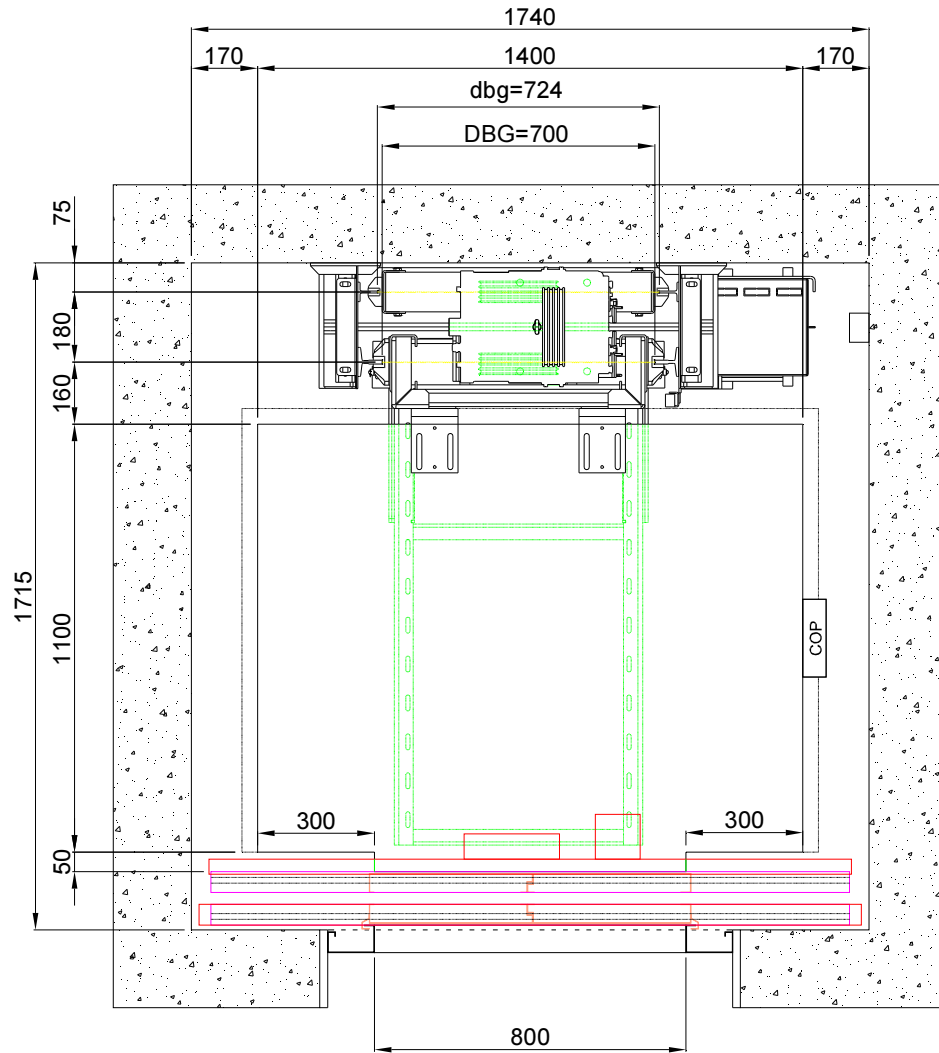

400Kg - 1100x1400mm - 4 panel center opening

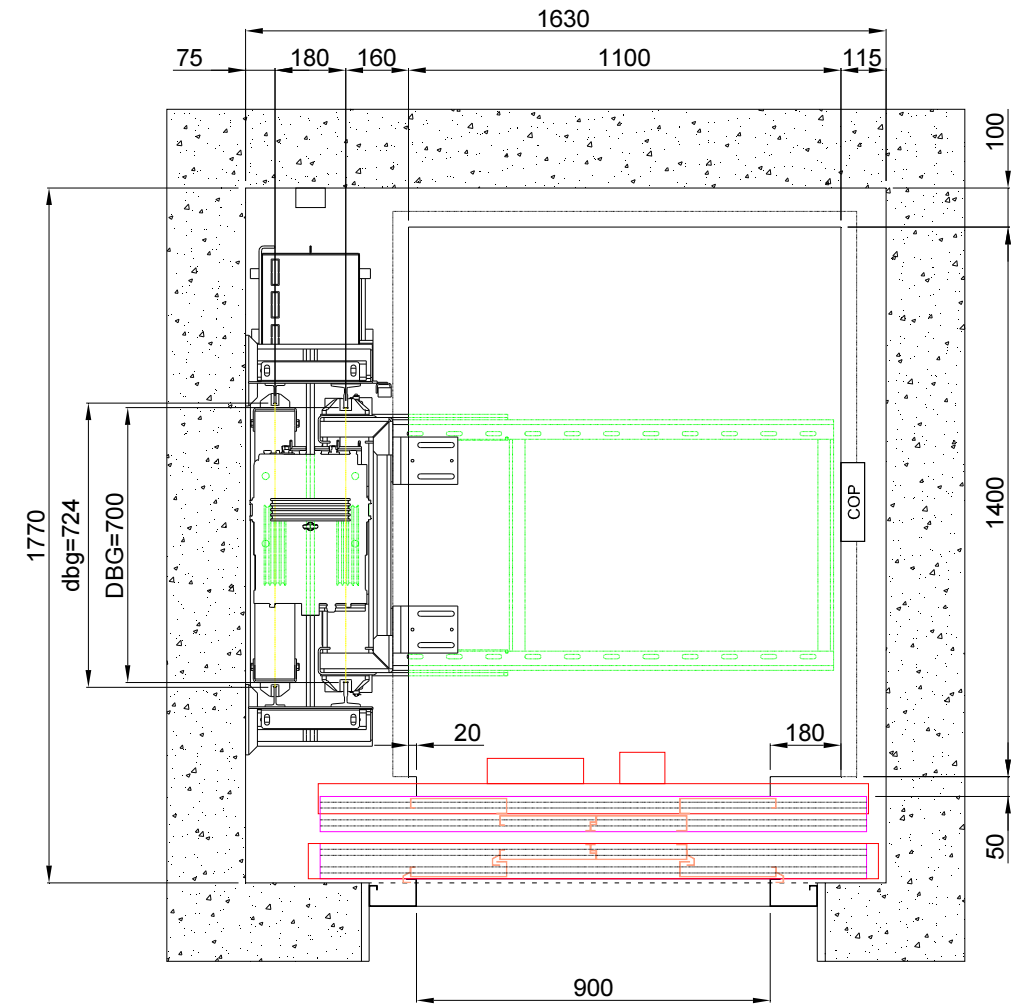
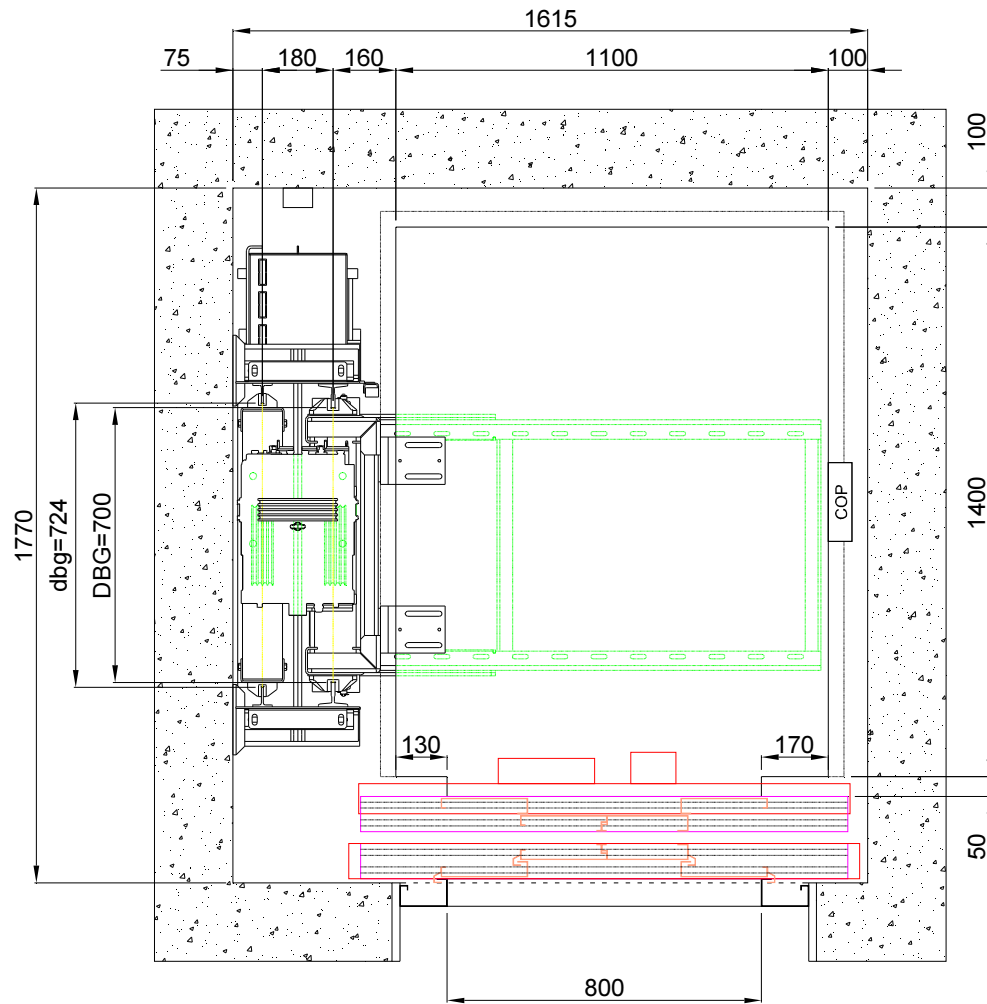

400Kg - 1100x1400mm - 4 panel center opening

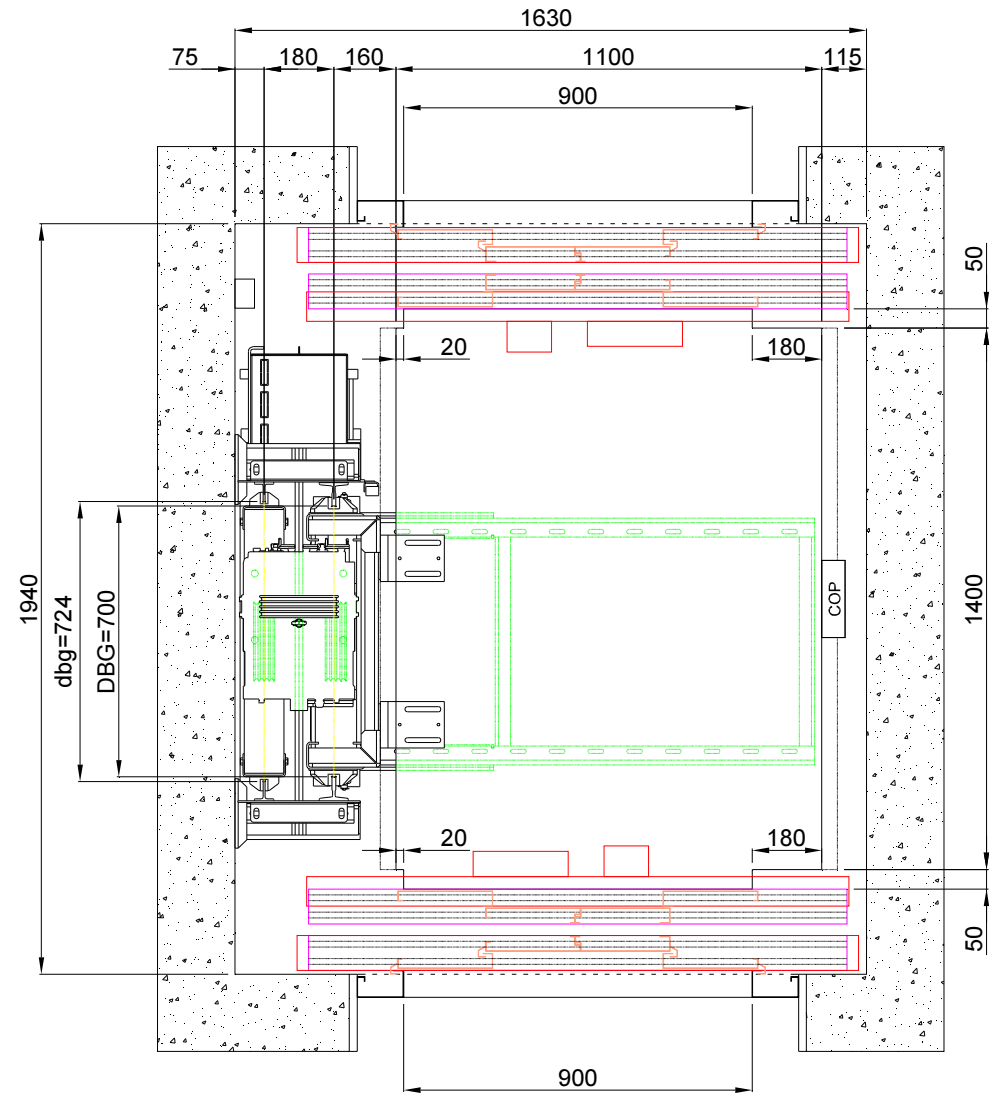
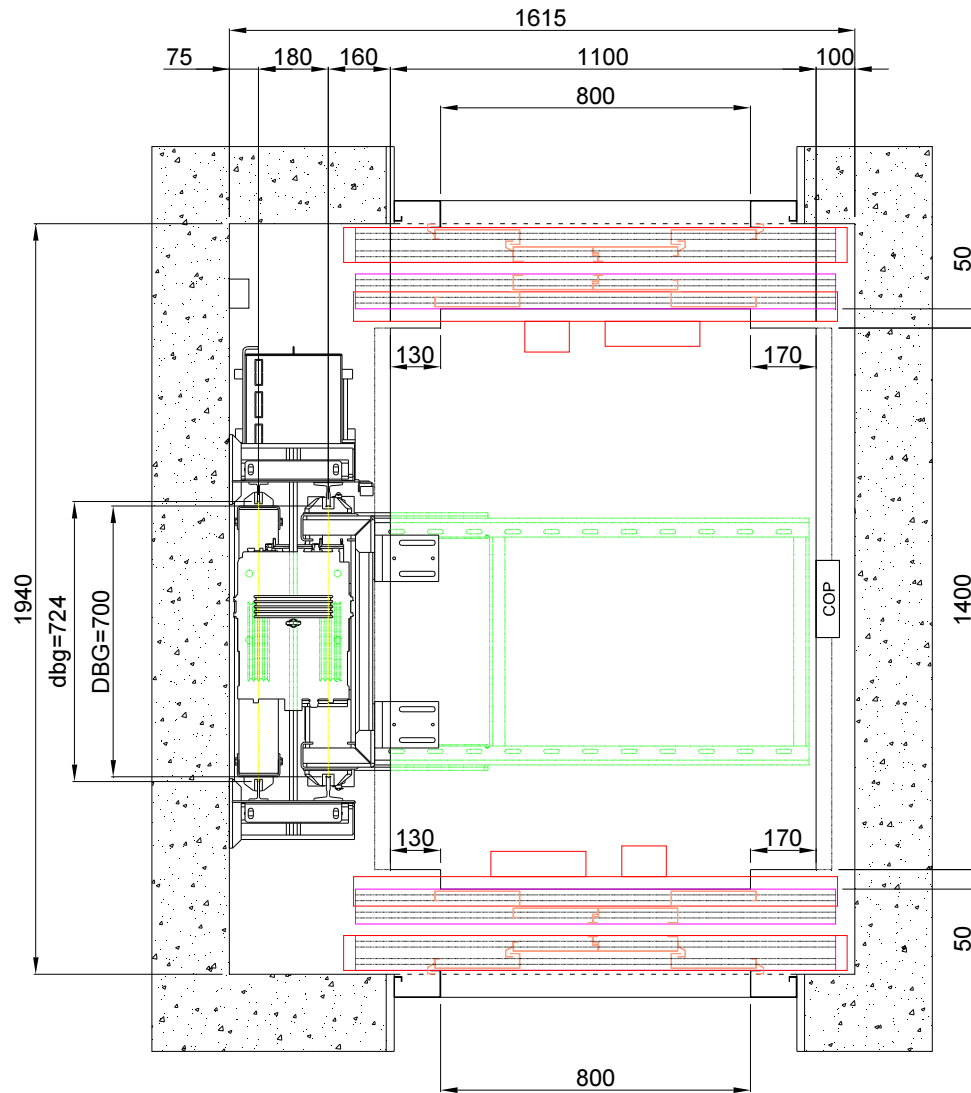

400Kg - 1100x1400mm - 4 panel center opening

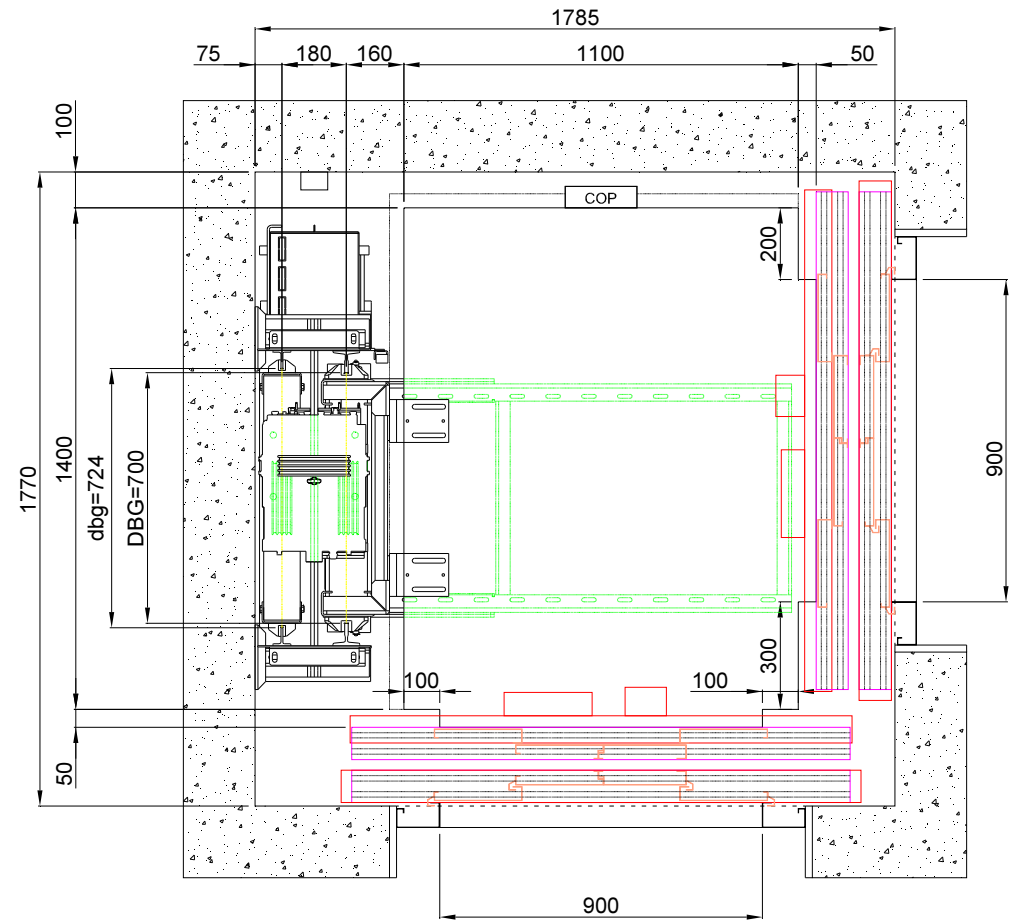
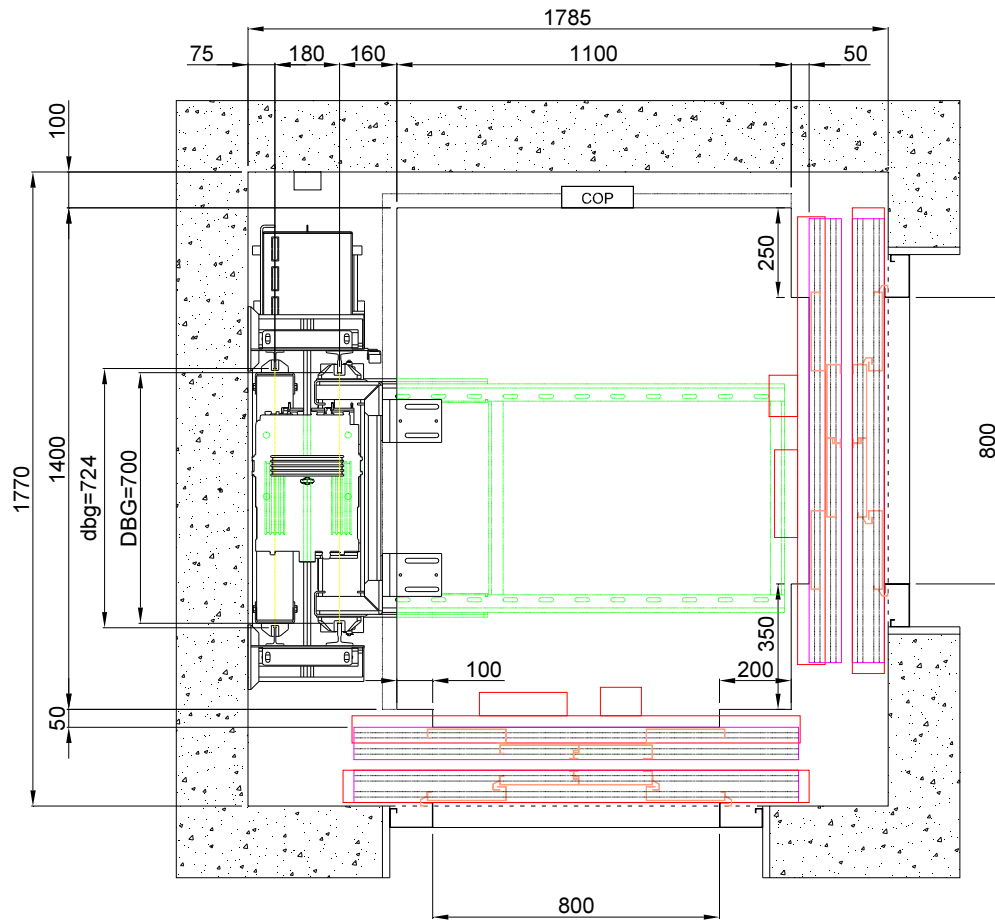

400Kg - 1400x1100mm - 4 panel center opening

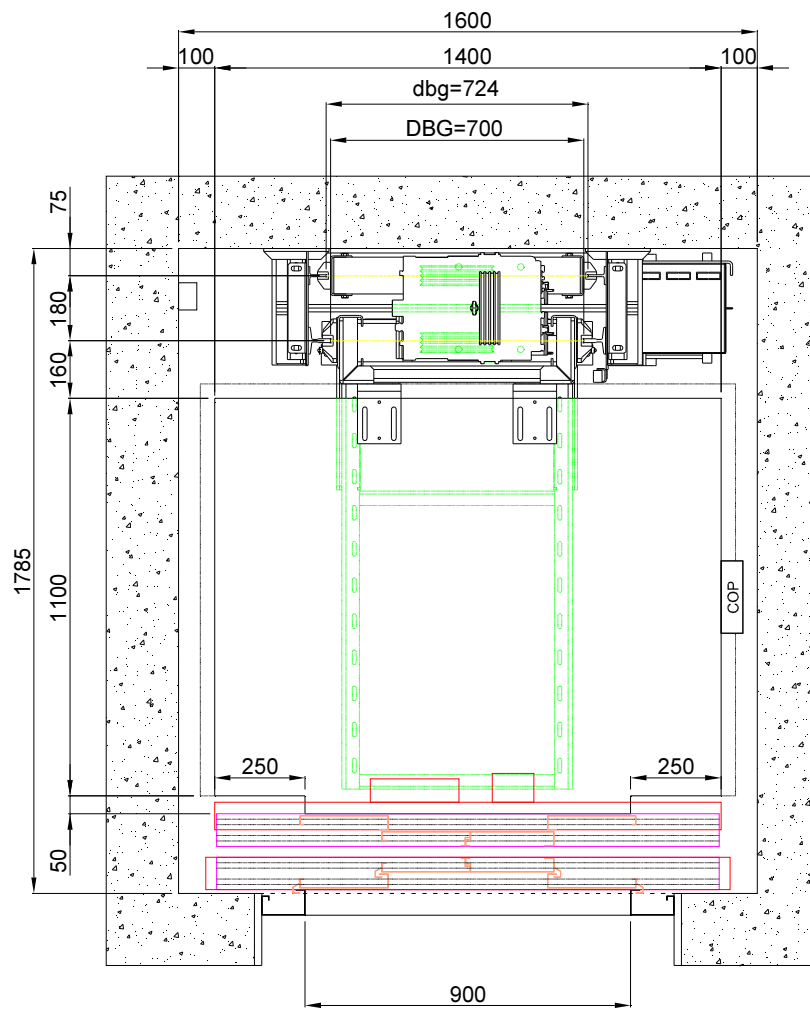
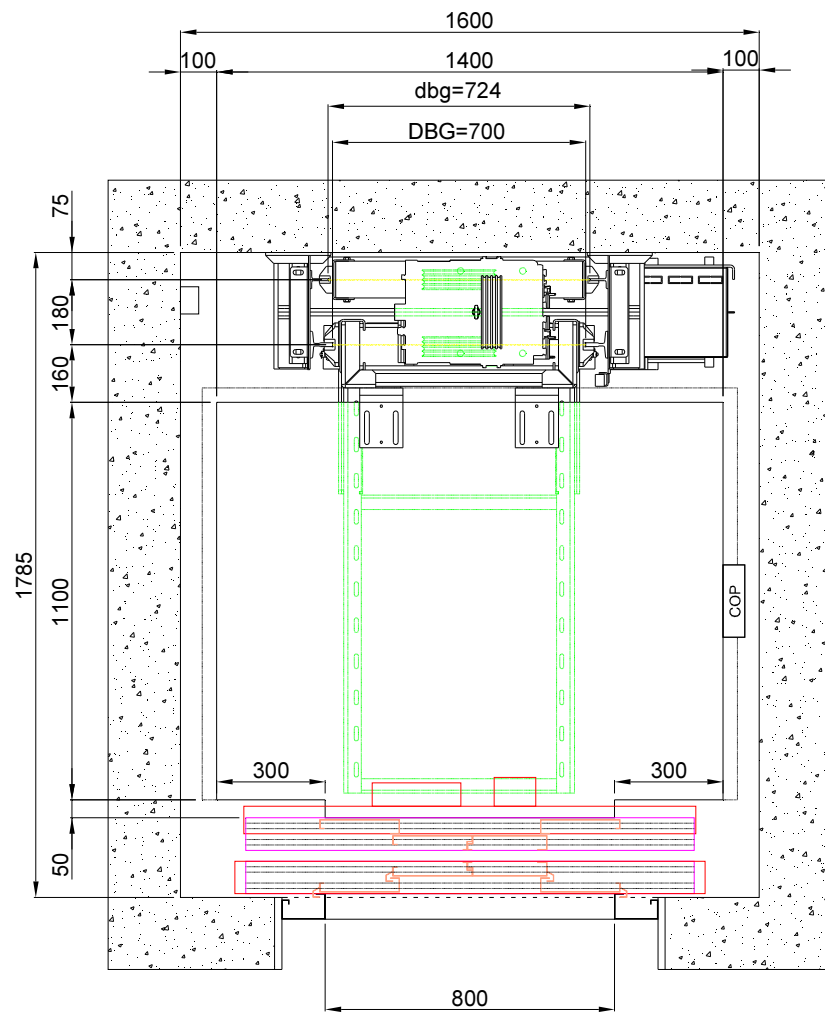

400Kg - 1100x1400mm - semi automatic with bus

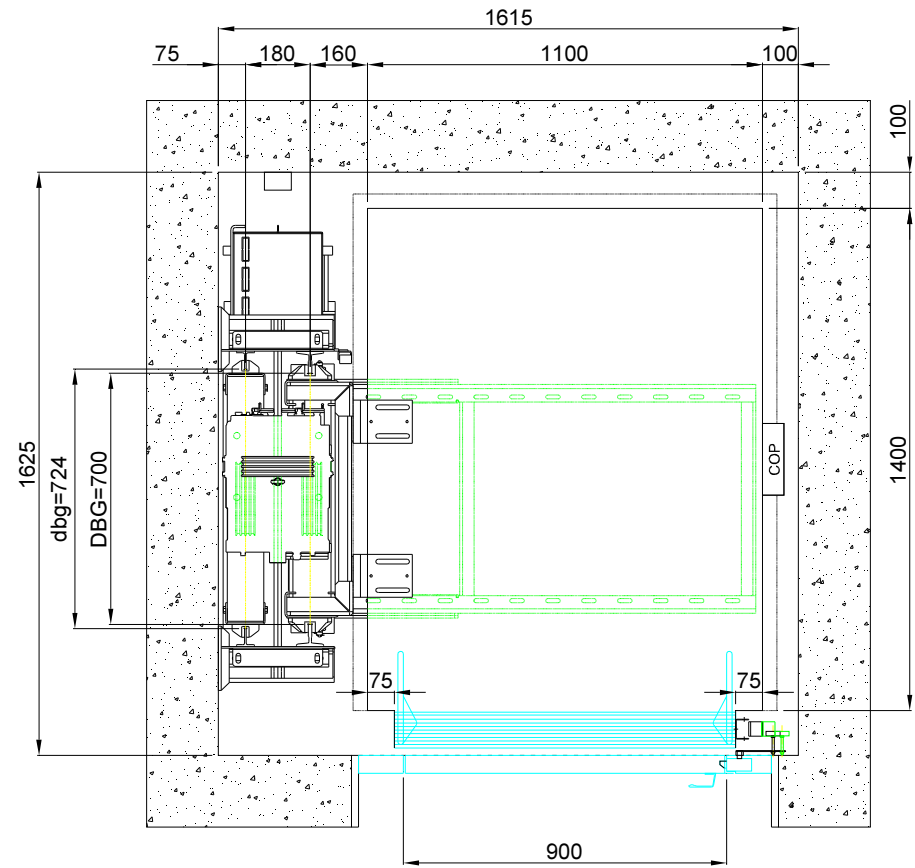
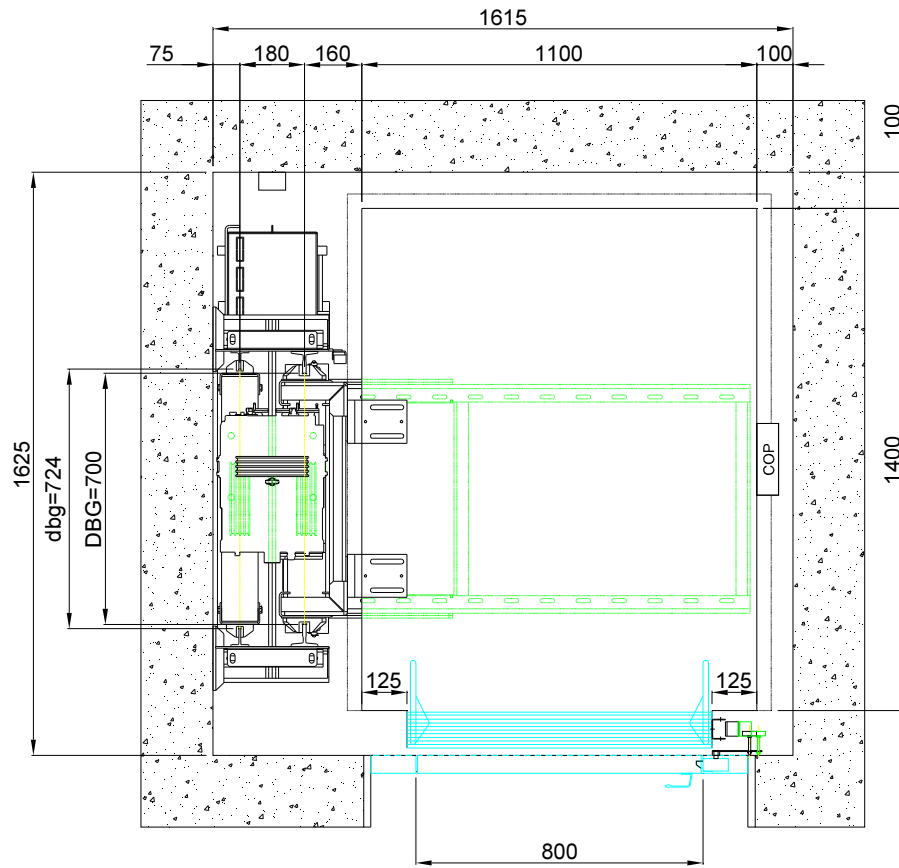

400Kg - 1100x1400mm - semi automatic with

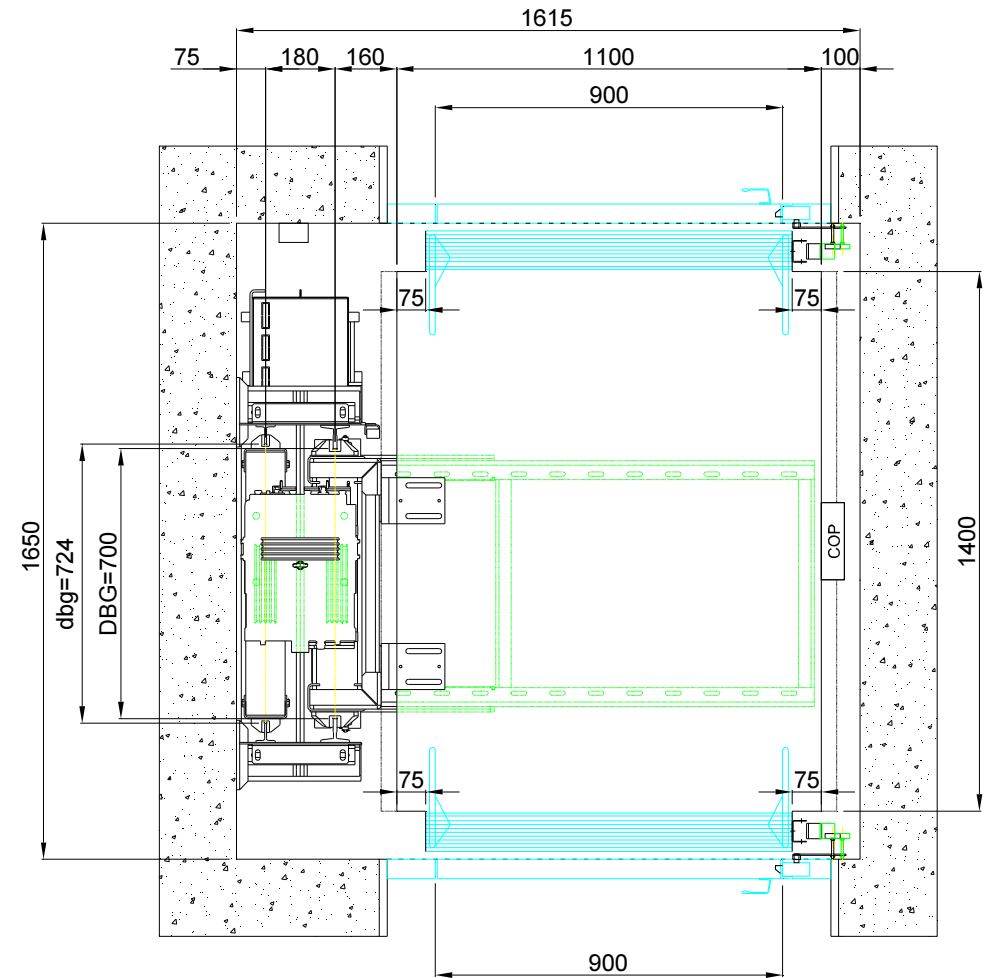
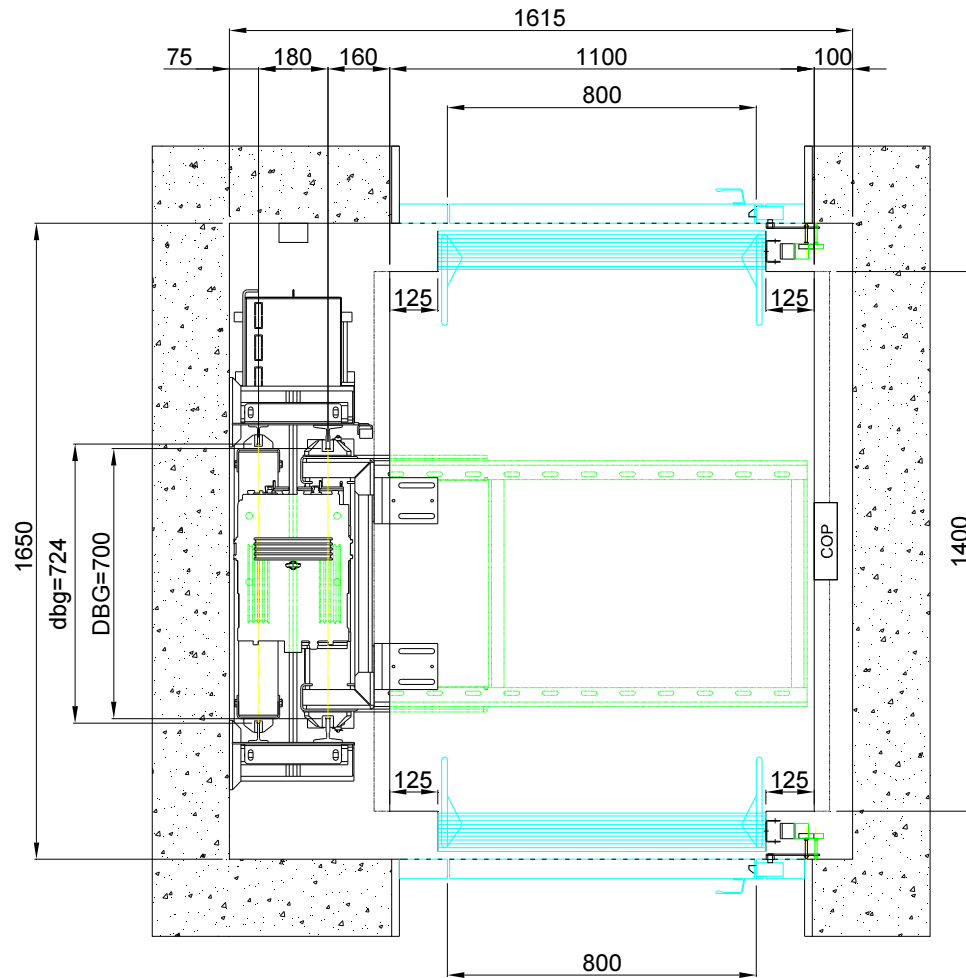

400Kg - 1100x1400mm - semi automatic with

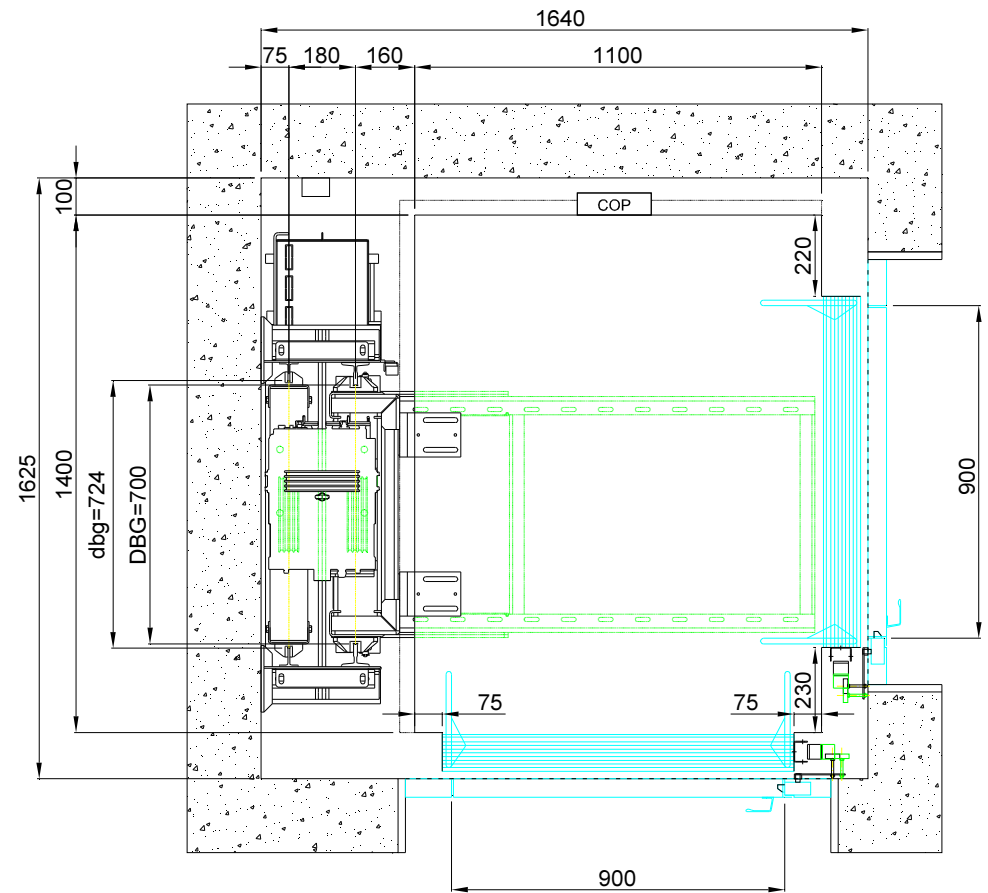
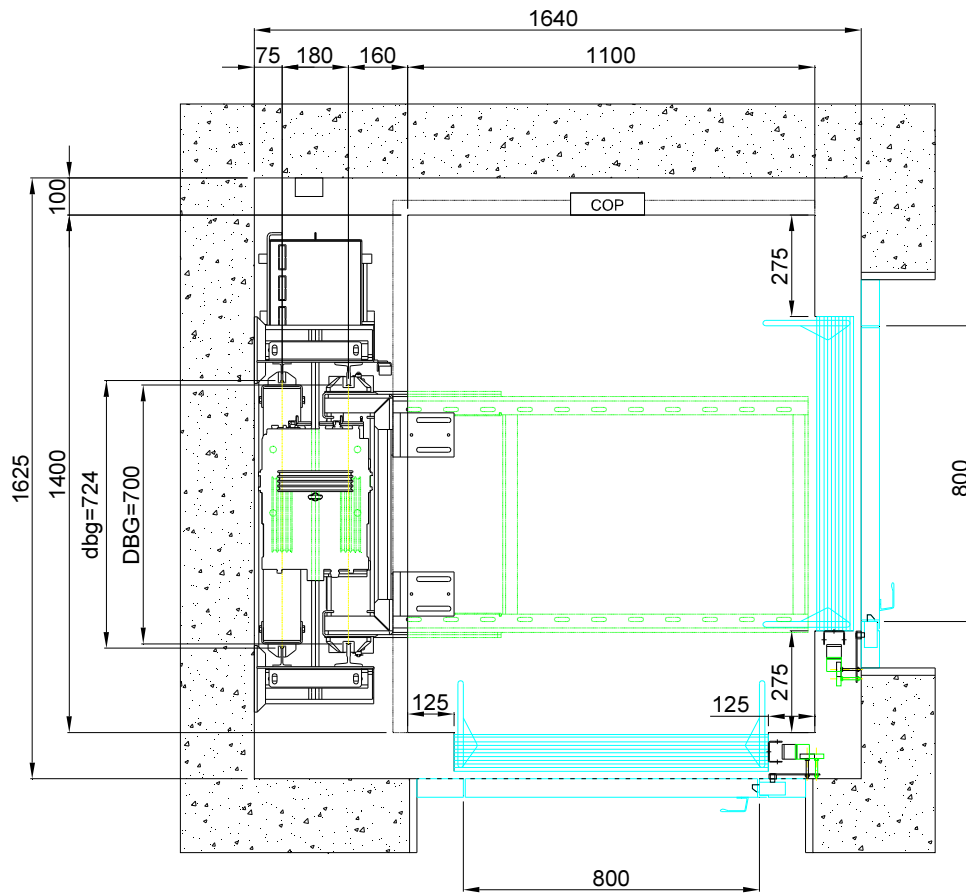

400Kg - 1400x1100mm - semi automatic with bus

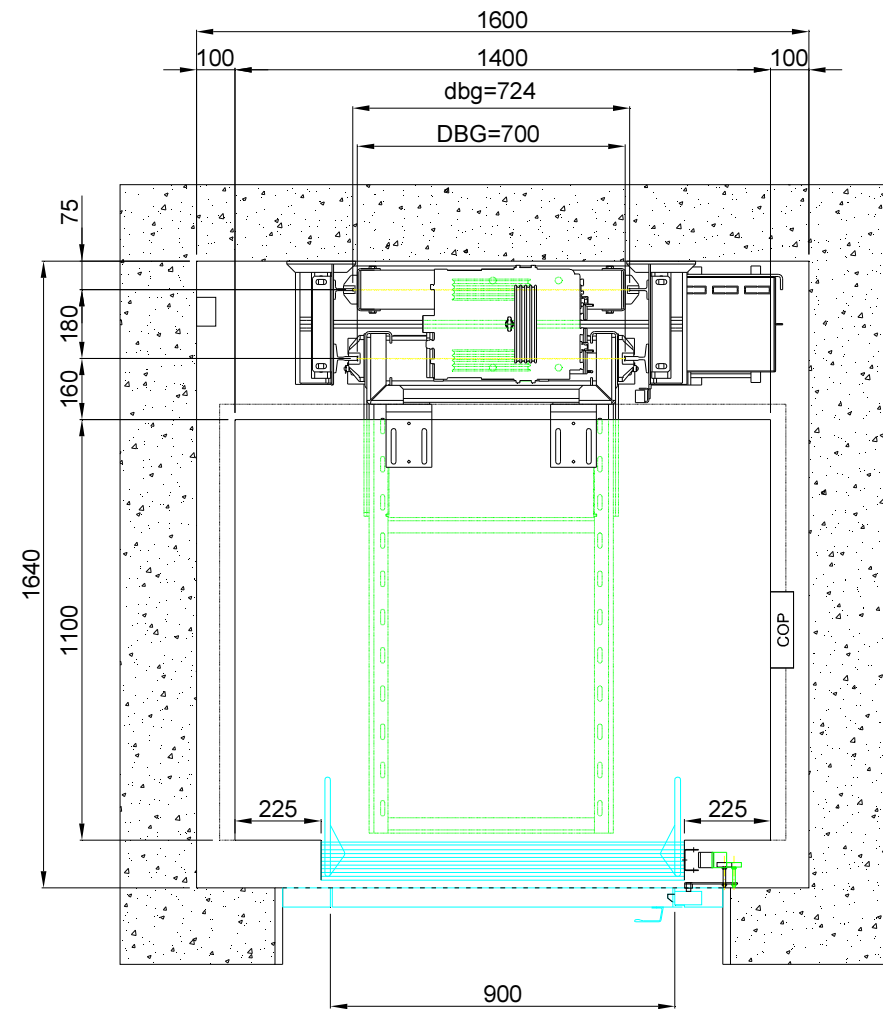
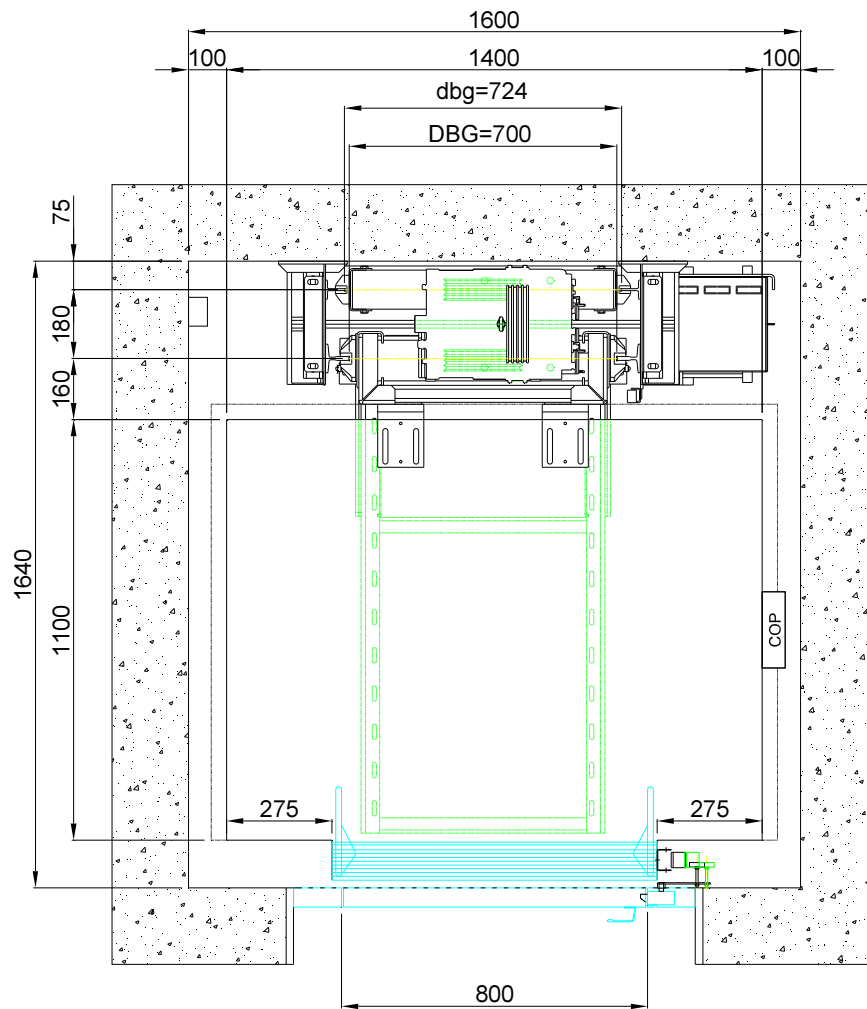

4. Shaft cross section

